



Government Gazette

OF THE STATE OF

NEW SOUTH WALES

Week No. 41/2012

Friday, 12 October 2012

*Published under authority by
Department of Premier and Cabinet
Level 11, Bligh House
4-6 Bligh Street, SYDNEY NSW 2000
Phone: 9228 3120 Fax: 9372 7422
Email: nswgazette@dpc.nsw.gov.au*

*Containing numbers 106 and 107
Pages 4319 – 4364*

CONTENTS

Number 106

SPECIAL SUPPLEMENT

Writ of Election – Sydney 4319

Number 107

LEGISLATION

Online notification of the making of Statutory
Instruments..... 4321

OFFICIAL NOTICES

Appointments 4323
Roads and Maritime Services 4324
Department of Trade and Investment, Regional
Infrastructure and Services 4329
Primary Industries 4332
Lands..... 4335
Other Notices 4351

PRIVATE ADVERTISEMENTS

(Council, Probate, Company Notices, etc)..... 4360

DEADLINES

Attention Advertisers . . .

Government Gazette inquiry times are:

Monday to Friday: 8.30 am to 4.30 pm

Phone: (02) 9228 3120 Fax: (02) 9372 7422

Email: nswgazette@dpc.nsw.gov.au

GOVERNMENT GAZETTE DEADLINES

Close of business every Wednesday

Except when a holiday falls on a Friday, deadlines will be altered as per advice given on this page.

Special Supplements

A Special Supplement or Extraordinary Supplement is a document which has a legal requirement to commence on a certain date and time. Release of Publication is required on the same day. The request for a Supplement is received from the department to the *Government Gazette* by telephone. The copy must be accompanied by a letter or email requesting the Supplement and signed by a Minister or Head of a Department.

NOTE: Advance notice of a Special Supplement is essential as early as possible on the day required. On Thursdays early notice is a priority and when possible notice should be given a day prior being the Wednesday.

Please Note:

- *Only electronic lodgement of Gazette contributions will be accepted. If you have not received a reply confirming acceptance of your email by the close of business on that day please phone 9228 3120.*

Department of Finance and Services Tenders

SUPPLIES AND SERVICES FOR THE PUBLIC SERVICE

Information in relation to the Department of Finance and Services proposed, current and awarded tenders is available on:

<http://www.tenders.nsw.gov.au>

*SEE the Government Gazette website at:
<http://nsw.gov.au/gazette>*



Government Gazette

OF THE STATE OF
NEW SOUTH WALES

Number 106
Monday, 8 October 2012

Published under authority by the Department of Premier and Cabinet

SPECIAL SUPPLEMENT

LEGISLATIVE ASSEMBLY

WRIT OF ELECTION

Legislative Assembly Office
Sydney, 8 October 2012

SHELLEY ELIZABETH HANCOCK, SPEAKER OF THE LEGISLATIVE ASSEMBLY of the State of New South Wales, in the Commonwealth of Australia, directs it to be notified, for general information, that a Writ hath this day been issued, and that the following arrangements have been made for the Election of a Member to serve in the present Legislative Assembly of the said State for the Electoral District of

SYDNEY

In the room of Clover Moore, resigned.

Date of Writ:	8 October 2012
Date of Nomination:	11 October 2012
Polling Day:	27 October 2012
Return of Writ:	7 November 2012

RONDA MILLER,
Clerk of the Legislative Assembly

ISSN 0155-6320

Authorised to be printed
TONY DUCKMANTON, Government Printer.



Government Gazette

OF THE STATE OF
NEW SOUTH WALES

Number 107
Friday, 12 October 2012

Published under authority by the Department of Premier and Cabinet

LEGISLATION

Online notification of the making of statutory instruments

Week beginning 1 October 2012

THE following instruments were officially notified on the NSW legislation website (www.legislation.nsw.gov.au) on the dates indicated:

Proclamations commencing Acts

- [City of Sydney Amendment \(Central Sydney Traffic and Transport Committee\) Act 2012 No 47 \(2012-498\)](#) — published LW 5 October 2012
- [Crime Commission Act 2012 No 66 \(2012-499\)](#) — published LW 5 October 2012
- [Government Advertising Act 2011 No 35 \(2012-500\)](#) — published LW 5 October 2012
- [Water Management Act 2000 No 92 \(2012-495\)](#) — published LW 4 October 2012

Regulations and other statutory instruments

- [Crime Commission Regulation 2012 \(2012-501\)](#) — published LW 5 October 2012
- [Criminal Assets Recovery Amendment Regulation 2012 \(2012-502\)](#) — published LW 5 October 2012
- [Government Advertising Regulation 2012 \(2012-503\)](#) — published LW 5 October 2012
- [Police Amendment \(Legal Advice Disclosure\) Regulation 2012 \(2012-504\)](#) — published LW 5 October 2012
- [Police Amendment \(Targeted Tests\) Regulation 2012 \(2012-505\)](#) — published LW 5 October 2012
- [Water Management \(Application of Act to Certain Water Sources\) Proclamation \(No 2\) 2012 \(2012-496\)](#) — published LW 4 October 2012
- [Water Management \(General\) Amendment \(Water Sharing Plans\) Regulation 2012 \(2012-497\)](#) — published LW 4 October 2012
- [Water Sharing Plan for the Barwon-Darling Unregulated and Alluvial Water Sources 2012 \(2012-488\)](#) — published LW 4 October 2012
- [Water Sharing Plan for the Belubula Regulated River Water Source 2012 \(2012-489\)](#) — published LW 4 October 2012
- [Water Sharing Plan for the Macquarie Bogan Unregulated and Alluvial Water Sources 2012 \(2012-490\)](#) — published LW 4 October 2012
- [Water Sharing Plan for the Murrumbidgee Regulated River Water Source Amendment Order 2012 \(2012-491\)](#) — published LW 4 October 2012
- [Water Sharing Plan for the Murrumbidgee Unregulated and Alluvial Water Sources 2012 \(2012-492\)](#) — published LW 4 October 2012

Water Sharing Plan for the Namoi Unregulated and Alluvial Water Sources 2012 (2012-493) — published LW 4 October 2012

Water Sharing Plan for the Phillips Creek, Mooki River, Quirindi Creek and Warrah Creek Water Sources Amendment Order 2012 (2012-494) — published LW 4 October 2012

Environmental Planning Instruments

Gunnedah Local Environmental Plan 2012 (Amendment No 1) (2012-508) — published LW 5 October 2012

Standard Instrument (Local Environmental Plans) Amendment (Definitions) Order 2012 (2012-506) — published LW 5 October 2012

State Environmental Planning Policy (Affordable Rental Housing) Amendment (Group Homes) 2012 (2012-507) — published LW 5 October 2012

The Hills Local Environmental Plan 2012 (2012-509) — published LW 5 October 2012

OFFICIAL NOTICES**Appointments**

**GAMING AND LIQUOR ADMINISTRATION
ACT 2007**

Department of Trade and Investment, Regional
Infrastructure and Services

Appointment of Member to the Independent Liquor
and Gaming Authority

HER Excellency the Governor, with the advice of the Executive Council, has appointed Sharryn Dawn BROWNLEE under section 7 (1) (b) of the Gaming and Liquor Administration Act 2007 as a part-time member of the Independent Liquor and Gaming Authority for a period of twelve months from 10 October 2012.

GEORGE SOURIS, M.P.,
Minister for Tourism, Major Events, Hospitality
and Racing and Minister for the Arts

Roads and Maritime Services

ROAD TRANSPORT (GENERAL) ACT 2005

Ministerial Declaration (Charitable Purposes Exemption) Order 2012

I, DUNCAN GAY, M.L.C., Minister for Roads and Ports, pursuant to section 16 of the Road Transport (General) Act 2005, make the following Order.

Dated this 3rd day of May 2012.

DUNCAN GAY, M.L.C.,
Minister for Roads and Ports

1. Citation

This Order is the Ministerial Declaration (Charitable Purposes Exemption) Order 2012.

2. Commencement

This Order takes effect on the later of 1 July 2012, or publication in the *New South Wales Government Gazette*.

3. Effect

This Order remains in force until 30 June 2014, unless revoked earlier.

4. Definitions

For the purposes of this order the following words have the meanings ascribed to them:

charitable purposes means any charitable, benevolent or philanthropic purpose including, without limitation, fund raising for children's charities.

fund raiser means Mr Terry O'Grady (also known as Tex O'Grady).

Unless stated otherwise, words and expressions used in this Order have the same meaning as those defined in the Road Rules 2008.

5. Declaration

The provisions of Road Rule 297 (3) of the Road Rules 2008 are declared not to apply to the fund raiser in the following circumstances:

- (a) the fund raiser is riding a motor bike to, from or for the purposes of events or activities conducted for charitable purposes; and
- (b) a copy of this Order as published in the *New South Wales Government Gazette*, is carried by the fund raiser at the time and is produced upon request by NSW Police.

Explanatory Notes:

Road Rule 297 (3) applies to prohibit the riding of a motor bike with an animal on the petrol tank.

The named fund raiser conducts significant charitable and fund raising activities for children's charities.

This Order applies to declare that the provisions of Road Rule 297 (3) do not apply to the named fund raiser in specified circumstances to enable charitable or fund raising activities for a limited period of 2 years.

Other than as provided for in this Order, the named fund raiser is required to comply with all other applicable Road Rules.

This Order only applies in New South Wales.

ROAD TRANSPORT (GENERAL) ACT 2005

Notice under Clause 20 the Road Transport (Mass, Loading and Access) Regulation 2005

RICHMOND VALLEY COUNCIL, in pursuance of Division 4 of Part 2 of the Road Transport (Mass, Loading, Access) Regulation 2005, by this Notice, specify the routes and areas on or in which 4.6 metre High Vehicles may be used subject to any requirements or conditions set out in the Schedule.

Date: 10 October 2012.

JOHN WALKER,
General Manager,
Richmond Valley Council
(by delegation from the Minister for Roads)

SCHEDULE
1. Citation

This Notice may be cited as Richmond Valley Council 4.6 Metre High Vehicle Route Notice No. 01/2012.

2. Commencement

This Notice takes effect from date of gazettal.

3. Effect

This Notice remains in force until 1 September 2015 unless it is amended or repealed earlier.

4. Application

This Notice applies to those 4.6 metre high vehicles which comply with Schedule 1 of the Road Transport (Mass, Loading and Access) Regulation 2005 and Schedule 2 of the Road Transport (Vehicle Registration) Regulation 2007.

5. Routes

<i>Type</i>	<i>Road No.</i>	<i>Road Name</i>	<i>Starting Point</i>	<i>Finishing Point</i>
4.6	665	Dargaville Drive	Reynolds Road	Casino Saleyards

ROAD TRANSPORT (GENERAL) ACT 2005

Notice under the Road Transport (Mass, Loading and Access) Regulation 2005

I, PETER DUNCAN, Chief Executive, Roads and Maritime Services, pursuant to Clause 20 of the Road Transport (Mass, Loading and Access) Regulation 2005, hereby amend the Class 2 Modular B-Triple Notice 2012, as published in the *New South Wales Government Gazette* No. 100 on 28 September 2012, at pages 4057 to 4111, as set out in the Schedule of this Notice.

PETER DUNCAN,
Chief Executive,
Roads and Maritime Services

SCHEDULE
1. Citation

This Notice is the Roads and Maritime Services Class 2 Modular B-Triple (Amendment) Notice No. 1/2012.

2. Commencement

This Notice takes effect on and from the date of publication in the *New South Wales Government Gazette*.

3. Effect

This Notice remains in force up to and including 30 September 2017, unless it is repealed earlier.

4. Amendment

Delete the following routes from the table at Appendix 1, under the heading PART 1 – Approved 35 Metre Modular B-Triple Routes Balranald Shire Council.

<i>Type</i>	<i>Road No.</i>	<i>Road Name</i>	<i>Starting Point</i>	<i>Finishing Point</i>
35MB3.	514.	Oxley Road (Hay Penarie Road).	HW21 Cobb Highway.	MR67 Balranald / Ivanhoe Road.

Insert the following routes into the table at Appendix 1, under the heading PART 1 – Approved 35 Metre Modular B-Triple Routes South West Region.

<i>Type</i>	<i>Road No.</i>	<i>Road Name</i>	<i>Starting Point</i>	<i>Finishing Point</i>
35MB3.	21.	Cobb Highway.	Nicholas Drive, Moama NSW / Victorian Border.	Central Darling / Carrathool Shire Boundary.

Insert the following routes into the table at Appendix 1, under the heading PART 1 – Approved 35 Metre Modular B-Triple Routes Balranald Shire Council.

<i>Type</i>	<i>Road No.</i>	<i>Road Name</i>	<i>Starting Point</i>	<i>Finishing Point</i>
35MB3.	514.	Oxley Road (Hay Penarie Road).	Balranald / Hay Shire Boundary.	MR67 Balranald / Ivanhoe Road.

Insert the following routes into the table at Appendix 1, under the heading PART 1 – Approved 35 Metre Modular B-Triple Routes Hay Shire Council.

<i>Type</i>	<i>Road No.</i>	<i>Road Name</i>	<i>Starting Point</i>	<i>Finishing Point</i>
35MB3.	514.	Oxley Road (Hay Penarie Road).	HW21 Cobb Highway.	Balranald / Hay Shire Boundary.

ROAD TRANSPORT (GENERAL) ACT 2005

Notice under the Road Transport (Mass, Loading and Access) Regulation 2005

I, PETER DUNCAN, Chief Executive, Roads and Maritime Services, pursuant to Clause 20 of the Road Transport (Mass, Loading and Access) Regulation 2005, hereby amend the Class 2 B-Double Notice 2010, as published in the *New South Wales Government Gazette* No. 108 on 27 August 2010, at pages 4033 to 4284, as set out in the Schedule of this Notice.

PETER DUNCAN,
Chief Executive,
Roads and Maritime Services

SCHEDULE
1. Citation

This Notice is the Roads and Maritime Services Class 2 B-Double (Amendment) Notice No. 11/2012.

2. Commencement

This Notice takes effect on and from the date of publication in the *New South Wales Government Gazette*.

3. Effect

This Notice remains in force up to and including 1 September 2015, unless it is repealed earlier.

4. Amendment

Delete the following route from the table at Appendix 1, under the heading Part 4 – Hunter Region.

<i>Type</i>	<i>Road No.</i>	<i>Road Name</i>	<i>Starting Point</i>	<i>Finishing Point</i>
25.	504.	Avoca Drive, Erina to Kincumber.	The Entrance Road (HW30 – Central Coast Highway), Erina.	Bungoona Street, Kincumber.

Insert the following routes into the table at Appendix 1, under the heading Part 4 – Hunter Region.

<i>Type</i>	<i>Road No.</i>	<i>Road Name</i>	<i>Starting Point</i>	<i>Finishing Point</i>
25.	349.	Empire Bay Drive.	MR504 Avoca Drive, Kincumber.	RR7779 The Scenic Road, Kincumber.
25.	349.	Brisbane Water Drive.	HW30 Central Coast Highway, West Gosford.	George St, Woy Woy.
25.	349.	Railway Street.	George St, Woy Woy.	MR349 Charlton Road, Woy Woy.
25.	504.	Avoca Drive.	HW30 Central Coast Highway (The Entrance Road), Erina.	MR349 Empire Bay Drive, Kincumber.

ROADS ACT 1993**LAND ACQUISITION (JUST TERMS
COMPENSATION) ACT 1991**

Notice of Compulsory Acquisition of land
at Bathampton in the Bathurst Regional Council area

Roads and Maritime Services by its delegate declares, with the approval of Her Excellency the Governor, that the land described in the schedule below is acquired by compulsory process under the provisions of the Land Acquisition (Just Terms Compensation) Act 1991 for the purposes of the Roads Act 1993.

T D Craig
Manager, Compulsory Acquisition & Road Dedication
Roads and Maritime Services

SCHEDULE

ALL that piece or parcel of Crown land situated in the Bathurst Regional Council area, Parish of Cole and County of Bathurst, shown as Lot 2 Deposited Plan 1170925, being part of the land in Certificate of Title 7300/1151399.

(RMS Papers: SF2012/6653; RO 6/30.1172)

Department of Trade and Investment, Regional Infrastructure and Services

MINERAL RESOURCES

NOTICE is given that the following applications have been received:

EXPLORATION LICENCE APPLICATIONS

(T12-1212)

No. 4661, AXIS CONSULTANTS PTY LTD (ACN 006 804 708), area of 83 units, for Group 6, dated 10 September 2012. (Singleton Mining Division).

(T12-1239)

No. 4683, CARPENTARIA EXPLORATION LIMITED (ACN 095 117 981), area of 100 units, for Group 1, dated 4 October 2012. (Inverell Mining Division).

(T12-1240)

No. 4684, CLANCY EXPLORATION LIMITED (ACN 105 578 756), area of 60 units, for Group 1, dated 9 October 2012. (Orange Mining Division).

MINING LEASE APPLICATIONS

(T12-1513)

No. 435, NOVACOAL AUSTRALIA PTY. LIMITED (ACN 000 013 990), area of about 23.55 hectares, to mine for coal, dated 14 September 2012. (Singleton Mining Division).

(11-5476)

No. 436, NOVACOAL AUSTRALIA PTY. LIMITED (ACN 000 013 990), area of about 51.21 hectares, to mine for coal, dated 14 September 2012. (Singleton Mining Division).

The Hon. CHRIS HARTCHER, M.P.,
Minister for Resources and Energy

NOTICE is given that the following application has been granted:

EXPLORATION LICENCE APPLICATION

(T12-1046)

No. 4502, now Exploration Licence No. 7960, CGNM RESOURCES PTY LTD (ACN 139 443 137), County of Harden, Map Sheet (8528), area of 11 units, for Group 1, dated 22 August 2012, for a term until 22 August 2014.

The Hon. CHRIS HARTCHER, M.P.,
Minister for Resources and Energy

NOTICE is given that the following applications have been withdrawn:

EXPLORATION LICENCE APPLICATIONS

(T09-0255)

No. 129, METGASCO LTD (ACN 088 196 383), County of Drake, County of Richmond and County of Rous, Map Sheet (9440). Withdrawal took effect on 25 September 2012.

(T11-0345)

No. 4429, ARK MINES LIMITED (ACN 123 668 717), County of Flinders, Map Sheet (8134, 8234). Withdrawal took effect on 3 October 2012.

(T11-0382)

No. 4457, ST BARBARA LIMITED (ACN 009 165 066), County of Cunningham, Map Sheet (8432). Withdrawal took effect on 5 October 2012.

(T12-1235)

No. 4679, AUGUR RESOURCES LTD (ACN 106 879 690), County of Gordon, Map Sheet (8632). Withdrawal took effect on 28 September 2012.

The Hon. CHRIS HARTCHER, M.P.,
Minister for Resources and Energy

NOTICE is given that the following applications for renewal have been received:

(10-6504)

Exploration Licence No. 5359, MURRAY BASIN TITANIUM PTY LTD (ACN 082 497 827), area of 589 units. Application for renewal received 8 September 2012.

(10-6425)

Exploration Licence No. 5362, MURRAY BASIN TITANIUM PTY LTD (ACN 082 497 827), area of 256 units. Application for renewal received 9 October 2012.

(T02-0048)

Exploration Licence No. 6010, BIG ISLAND MINING PTY LTD (ACN 112 787 470), area of 4 units. Application for renewal received 9 October 2012.

(T02-0050)

Exploration Licence No. 6012, BIG ISLAND MINING PTY LTD (ACN 112 787 470), area of 6 units. Application for renewal received 8 October 2012.

(04-0524)

Exploration Licence No. 6319, ALKANE RESOURCES LTD (ACN 000 689 216), area of 7 units. Application for renewal received 3 October 2012.

(04-0538)

Exploration Licence No. 6320, ALKANE RESOURCES LTD (ACN 000 689 216), area of 36 units. Application for renewal received 3 October 2012.

(06-4081)

Exploration Licence No. 6648, GOSSAN HILL GOLD LIMITED (ACN 147 329 833), area of 9 units. Application for renewal received 8 October 2012.

(T10-0099)

Exploration Licence No. 7623, ARASTRA EXPLORATION PTY LTD (ACN 085 025 798), area of 30 units. Application for renewal received 4 October 2012.

(T10-0033)

Exploration Licence No. 7628, CENTRAL WEST GOLD NL (ACN 003 078 591), area of 2 units. Application for renewal received 8 October 2012.

(T09-0008)

Petroleum Exploration Licence No. 476, PANGAEA OIL & GAS PTY LIMITED (ACN 068 812 171), area of 104 blocks. Application for renewal received 3 October 2012.

The Hon. CHRIS HARTCHER, M.P.,
Minister for Resources and Energy

(06-0084)

Exploration Licence No. 6746 (Act 1992), OROYA MINING LIMITED (ACN 009 146 794), County of Dampier, Map Sheet (8925), area of 21 units. Request of cancellation was received on 4 October 2012.

(06-0085)

Exploration Licence No. 6747 (Act 1992), OROYA MINING LIMITED (ACN 009 146 794), County of Dampier and County of St Vincent, Map Sheet (8926), area of 31 units. Request of cancellation was received on 4 October 2012.

(T10-0035)

Exploration Licence No. 7629 (Act 1992), OROYA MINING LIMITED (ACN 009 146 794), County of Auckland and County of Wellesley, Map Sheet (8723), area of 46 units. Request of cancellation was received on 4 October 2012.

(T11-0116)

Exploration Licence No. 7850 (Act 1992), HEI LONG PTY LTD (ACN 150 046 969), County of Auckland, Map Sheet (8824), area of 13 units. Request of cancellation was received on 5 October 2012.

(T11-0117)

Exploration Licence No. 7851 (Act 1992), HEI LONG PTY LTD (ACN 150 046 969), County of Clive and County of Gough, Map Sheet (9239, 9339), area of 100 units. Request of cancellation was received on 5 October 2012.

The Hon. CHRIS HARTCHER, M.P.,
Minister for Resources and Energy

RENEWAL OF CERTAIN AUTHORITIES

NOTICE is given that the following authorities have been renewed:

(T03-1001)

Exploration Licence No. 6224, RAPTOR MINERALS LIMITED (ACN 101 168 343), Counties of Killara and Landsborough, Map Sheet (7736), area of 40 units, for a further term until 4 April 2014. Renewal effective on and from 8 October 2012.

(05-0306)

Exploration Licence No. 6516, NEW SOUTH RESOURCES LIMITED (ACN 119 557 416), County of Clarendon, Map Sheet (8428), area of 6 units, for a further term until 6 March 2014. Renewal effective on and from 17 September 2012.

(T09-0222)

Exploration Licence No. 7458, CENTIUS GOLD LIMITED (ACN 140 475 921), County of Clarendon, Map Sheet (8428), area of 31 units, for a further term until 26 February 2014. Renewal effective on and from 8 October 2012.

(T09-0276)

Exploration Licence No. 7472, GRIGM RESOURCES PTY LTD (ACN 148 051 567), Counties of Farnell, Mootwingee and Yancowinna, Map Sheet (7135, 7234, 7235), area of 79 units, for a further term until 16 March 2014. Renewal effective on and from 4 October 2012.

(T10-0027)

Exploration Licence No. 7503, CENTREX METALS LIMITED (ACN 096 298 752), County of Argyle, Map Sheet (8827, 8828), area of 16 units, for a further term until 7 April 2014. Renewal effective on and from 8 October 2012.

The Hon. CHRIS HARTCHER, M.P.,
Minister for Resources and Energy

CANCELLATION OF AUTHORITIES AT REQUEST OF HOLDERS

NOTICE is given that the following authorities have been cancelled:

(06-0082)

Exploration Licence No. 6716, OROYA MINING LIMITED (ACN 009 146 794), County of Auckland, Map Sheet (8823, 8824), area of 41 units. Cancellation took effect on 8 October 2012.

(06-0081)

Exploration Licence No. 6731, OROYA MINING LIMITED (ACN 009 146 794), County of Auckland, Map Sheet (8824), area of 14 units. Cancellation took effect on 8 October 2012.

(06-0084)

Exploration Licence No. 6746, OROYA MINING LIMITED (ACN 009 146 794), County of Dampier, Map Sheet (8925), area of 21 units. Cancellation took effect on 8 October 2012.

(06-0085)

Exploration Licence No. 6747, OROYA MINING LIMITED (ACN 009 146 794), County of Dampier and County of St Vincent, Map Sheet (8926), area of 31 units. Cancellation took effect on 8 October 2012.

(07-0110)

Exploration Licence No. 6802, CLANCY EXPLORATION LIMITED (ACN 105 578 756), County of Clarendon and County of Wynyard, Map Sheet (8427), area of 12 units. Cancellation took effect on 8 October 2012.

REQUESTED CANCELLATION OF AUTHORITIES AT REQUEST OF HOLDERS

NOTICE is given that the following authorities have been requested to be cancelled:

(06-0082)

Exploration Licence No. 6716 (Act 1992), OROYA MINING LIMITED (ACN 009 146 794), County of Auckland, Map Sheet (8823, 8824), area of 41 units. Request of cancellation was received on 4 October 2012.

(06-0081)

Exploration Licence No. 6731 (Act 1992), OROYA MINING LIMITED (ACN 009 146 794), County of Auckland, Map Sheet (8824), area of 14 units. Request of cancellation was received on 4 October 2012.

(T10-0035)

Exploration Licence No. 7629, OROYA MINING LIMITED (ACN 009 146 794), County of Auckland and County of Wellesley, Map Sheet (8723), area of 46 units. Cancellation took effect on 8 October 2012.

(T11-0116)

Exploration Licence No. 7850, HEI LONG PTY LTD (ACN 150 046 969), County of Auckland, Map Sheet (8824), area of 13 units. Cancellation took effect on 9 October 2012.

(T11-0117)

Exploration Licence No. 7851, HEI LONG PTY LTD (ACN 150 046 969), County of Clive and County of Gough, Map Sheet (9239, 9339), area of 100 units. Cancellation took effect on 9 October 2012.

The Hon. CHRIS HARTCHER, M.P.,
Minister for Resources and Energy

PRIMARY INDUSTRIES

FISHERIES MANAGEMENT ACT 1994

FISHERIES MANAGEMENT (AQUACULTURE) REGULATION 2012

Notification under Clause 27 (4)

Proposed Tender of Aquaculture Leases in Various Estuaries of NSW

NSW Department of Primary Industries (NSW DPI) is offering by public tender twenty three (23) areas of public water land in various estuaries of NSW, for the purpose of oyster aquaculture.

<i>Lease No.</i>	<i>Lease Area (ha)</i>	<i>Estuary/Location</i>	<i>OISAS status</i>	<i>GIS survey available</i>
OL91/024	2.0484	Macleay River	POAA	Yes
OL69/604	0.4398	Manning River	POAA	Yes
OL70/403	0.6904	Manning River	POAA	Yes
OL76/216	0.9833	Manning River	POAA	Yes
OL80/006	0.3003	Manning River	POAA	Yes
OL80/250	0.6608	Manning River	POAA	Yes
OL80/251	0.9247	Manning River	POAA	Yes
OL92/029	1.037	Manning River	POAA	Yes
OL96/075	1.3234	Manning River	POAA	Yes
OL84/061	0.2577	Wallis Lake	POAA	Yes
OL93/002	0.6912	Wallis Lake	POAA	Yes
OL60/017	0.7264	Port Stephens	POAA	Yes
OL62/015	0.8382	Port Stephens	POAA	Yes
OL88/089	1.4342	Port Stephens	POAA	Yes
OL96/022	0.6986	Brisbane Water	POAA	Yes
OL60/114	2.4797	Hawkesbury River	POAA	Yes
OL61/154	2.3085	Hawkesbury River	Non-POAA	Yes
AL11/012	1.2 (approx.)	Botany Bay	Non-POAA	No
OL86/013	0.4324	Crookhaven River	National Park	Yes
AL12/002	1.64	Wagonga Inlet	POAA	No
OL63/020	0.7221	Wagonga Inlet	POAA	Yes
OL77/005	0.1785	Wagonga Inlet	POAA	Yes
AL12/001	0.24	Pambula River	Non-POAA	No

All tenders must be marked 'Confidential' and submitted to: Tender Box, Port Stephens Fisheries Institute, Locked Bag 1, Nelson Bay NSW 2315. Tenders must be received at this address **no later than 4:30 pm on Friday, 9 November 2012.**

Proposed oyster leases OL61/154 and AL12/001 apply to an area of water which is not in a priority oyster aquaculture area (Non-POAA) under the NSW Oyster Industry Sustainable Aquaculture Strategy (OISAS). As such, the successful tenderer(s) of these leases will be required to obtain development consent from Council under Part 4 of the Environmental Planning and Assessment Act 1979.

Proposed oyster lease AL11/012 applies to an area of water within the Towra Point Aquatic Reserve and as such, the successful tenderer will be required to prepare a Review of Environmental Factors (REF), to be assessed and approved by NSW DPI.

An approved GIS survey is not available for proposed leases AL11/012, AL12/001 and AL12/002. The successful tenderer(s) will be required to obtain an approved survey, to be completed by a registered surveyor at the expense of the successful tenderer(s).

Any lease granted as a result of the tender will be subject to standard covenants and conditions of an aquaculture lease and aquaculture permit as prescribed under the Fisheries Management Act 1994, including payment of prescribed annual fees and charges. Lease rent is charged annually, currently at \$52 per hectare (excl. GST), which is subject to an annual Consumer Price Index adjustment. Tenure of a lease will be up to 15 years.

Leases will be tendered "as is" condition, where any existing improvements have not been valued and will become the responsibility of the leaseholder. An information package, which contains the Terms and Conditions of the tender and a tender form, can be obtained by contacting an Aquaculture Officer at the Port Stephens Fisheries Institute on (02) 4916 3919, or by visiting the department's website at www.dpi.nsw.gov.au.

BILL TALBOT,
Director,
Conservation, Aquaculture & Marine Parks,
Fisheries Division,
NSW Department of Primary Industries

FISHERIES MANAGEMENT ACT 1994
FISHERIES MANAGEMENT (AQUACULTURE)
REGULATION 2012

Section 177 (1) – Notice of Aquaculture
Lease Cancellation

OL69/584 within the estuary of Camden Haven, having an area of 0.792 hectares formerly leased by Shane HARPER.

OL81/179 within the estuary of Camden Haven, having an area of 0.1536 hectares formerly leased by Shane HARPER.

OL98/006 within the estuary of Camden Haven, having an area of 3.5271 hectares formerly leased by Shane HARPER.

Clause 31 (3) – Notice of Granting of Class 1
Aquaculture Lease

THE Minister has granted the following Class 1 Aquaculture Lease:

AL04/012 within the estuary of the Crookhaven River, having an area of 0.9204 hectares to Garry COLLISON and Robin COLLISON of Nowra Hill NSW, for a term of 15 years expiring on 27 July 2027.

AL04/013 within the estuary of the Crookhaven River, having an area of 1.2527 hectares to Garry COLLISON and Robin COLLISON of Nowra Hill NSW, for a term of 15 years expiring on 27 July 2027.

Clause 33 (4) – Notice of Aquaculture Lease Renewal

THE Minister has renewed the following Class 1 Aquaculture Leases:

OL96/002 within the estuary of Merimbula Lake, having an area of 1.8508 hectares to Darren Allan DEATH of Wallagoot NSW, for a term of 15 years expiring on 25 November 2027.

OL66/114 within the estuary of Camden Haven, having an area of 0.5101 hectares to John EGGINS, Joshua DUNN and Brian EGGINS of Laurieton NSW, for a term of 15 years expiring on 29 August 2027.

BILL TALBOT,
Director,
Aquaculture, Conservation and Marine Parks,
Fisheries Division,
NSW Department of Primary Industries

**FORESTRY COMMISSION OF
NEW SOUTH WALES**

Forfeited Holding

IT is hereby notified that the undermentioned holding and all rights attached to such holding has become and is hereby forfeited for non-payment of Crown dues, but such forfeiture shall not take effect until the expiration of thirty clear days after this notification.

Dated: Sydney, 12 October 2012.

KATRINA ANN HODGKINSON, M.P.,
Minister for Primary Industries

*Land District of Kempsey;
Armidale Dumaresq Council Area;
Central Forestry Region*

Conditional Lease 1910/31, Lot 3 in Deposited Plan 756486, Parish of Kunderang, County of Vernon, of 54.8 hectares, holders, Mitchell David ELVIN and Paul MOWBRAY. (10213)

**FORESTRY COMMISSION OF
NEW SOUTH WALES**

Forfeited Holding

IT is hereby notified that the undermentioned holding and all rights attached to such holding has become and is hereby forfeited for non-payment of Crown dues, but such forfeiture shall not take effect until the expiration of thirty clear days after this notification.

Dated: Sydney, 12 October 2012.

KATRINA ANN HODGKINSON, M.P.,
Minister for Primary Industries

*Land District of Kempsey;
Armidale Dumaresq Council Area;
Central Forestry Region*

Crown-lease 1931/2, Lot 93 in Deposited Plan 751451, Parish of Dyke, County of Clarke, of 297.8 hectares, holder, Lynne HIBBERT. (1278)

PLANT DISEASES ACT 1924

Appointment of Inspector

I, ANDREW COLIN SANGER, Director, Agricultural Compliance, with the delegated authority of the Director General of the Department of Trade and Investment, Regional Infrastructure and Services, pursuant to section 28C of the Plant Diseases Act 1924 (“the Act”) and pursuant to section 11 (1) of the Act, hereby appoint Bernard James MAHER as an inspector for the purposes of the Act.

Dated this 4th day of October 2012.

A. C. SANGER,
 Director, Agricultural Compliance,
 Department of Primary Industries
 (an office within the Department of Trade and
 Investment, Regional Infrastructure and Services)

STOCK DISEASES ACT 1923

Appointment of Inspectors

Notification No. 544

I, ANDREW COLIN SANGER, Director Agricultural Compliance, with the delegated authority of the Director General of the Department of Trade and Investment, Regional Infrastructure and Services, pursuant to section 22C of the Stock Diseases Act 1923 (“the Act”) and pursuant to section 6 (1) of the Act, hereby appoint Amy SHERGOLD and Stewart HINZE as inspectors for the purposes of the Act.

Dated this 4th day of October 2012.

A. C. SANGER,
 Director, Agricultural Compliance,
 Department of Primary Industries
 (an office within the Department of Trade and
 Investment, Regional Infrastructure and Services)

RURAL LANDS PROTECTION ACT 1998

Appointment of Authorised Officers

I, ANDREW COLIN SANGER, Director, Agricultural Compliance, with the delegated authority of the Director General of the Department of Trade and Investment, Regional Infrastructure and Services, pursuant to section 241 of the Rural Lands Protection Act 1998 (“the Act”), do by this instrument pursuant to section 185 of the Act appoint the persons named in the Schedule below as authorised officers for the purposes of the Act.

SCHEDULE

Megan-Jean PRATT
 Danielle MCKAY

Dated this 8th day of October 2012.

A. C. SANGER,
 Director, Agricultural Compliance,
 Department of Primary Industries
 (an office within the Department of Trade and
 Investment, Regional Infrastructure and Services)

LANDS

ARMIDALE CROWN LANDS OFFICE
108 Faulkner Street (PO Box 199A), Armidale NSW 2350
Phone: (02) 6770 3100 Fax (02) 6772 8782

NOTIFICATION OF CLOSING OF A ROAD

IN pursuance of the provisions of the Roads Act 1993, the road hereunder described is closed and the lands comprised therein cease to be public road and the rights of passage and access that previously existed in relation to the road is extinguished. Upon closing, title to the land, comprising the former public road, vests in the body specified in the Schedule hereunder.

ANDREW STONER, M.P.,
Minister for Regional Infrastructure and Services

—————
Description

Parish – Salway; County – Vernon;
Land District – Walcha; L.G.A. – Walcha

Road Closed: Lot 2, DP 1173997.

File No.: 10/03979.

Schedule

On closing, the land within Lot 2, DP 1173997 remains vested in the State of New South Wales as Crown Land.

DUBBO CROWN LANDS OFFICE
45 Wingewarra Street (PO Box 1840), Dubbo NSW 2830
Phone: (02) 6883 3300 Fax: (02) 6884 2067

**APPOINTMENT OF CORPORATION TO MANAGE
RESERVE TRUST**

PURSUANT to section 95 of the Crown Lands Act 1989, the corporation specified in Column 1 of the Schedule hereunder, is appointed to manage the affairs of the reserve trust specified opposite thereto in Column 2, which is trustee of the reserve referred to in Column 3 of the Schedule.

ANDREW STONER, M.P.,
Minister for Regional Infrastructure and Services

SCHEDULE

<i>Column 1</i>	<i>Column 2</i>	<i>Column 3</i>
Dunedoo Urban Landcare Group Inc.	Dunedoo Environmental Protection Reserve Trust.	Reserve No.: 120112. Public Purpose: Environmental protection. Notified: 23 August 1996. File No.: DB96 R 15.

For a term commencing the date of this notice.

NOTIFICATION OF CLOSING OF A ROAD

IN pursuance of the provisions of the Roads Act 1993, the road hereunder described is closed and the lands comprised therein cease to be public road and the rights of passage and access that previously existed in relation to the road is extinguished. Upon closing, title to the land, comprising the former public road, vests in the body specified in the Schedule hereunder.

ANDREW STONER, M.P.,
Minister for Regional Infrastructure and Services

Description

*Parish of Dubbo; County of Lincoln;
Land District – Dubbo; L.G.A. – Dubbo City Council*

Road Closed: Lot 10, DP 1176485.

File No.: 12/02647 – W499553.

Schedule

Dubbo City Council.

GRAFTON OFFICE
49-51 Victoria Street (PO Box 272), Grafton NSW 2460
Phone: (02) 6640 3400 Fax: (02) 6642 5375

ROADS ACT 1993**ORDER**

Correction of Defective Instrument

AS per the Notification of Closing of a Road which appeared in *New South Wales Government Gazette*, dated 10 August 2012, Folio 3667, part of the description is hereby amended. Under heading of "Description" the words "Land District – Grafton, L.G.A. – Clarence Valley, Road Closed Lot 1, DP 1176313"; are deleted and replaced with "Land District – Lismore, L.G.A. – Lismore, Road Closed: Lot 1, DP 1176288".

Reference: 07/5170.

ERRATUM

IN the notification appearing in the *New South Wales Government Gazette* No. 105, Folio 4299, of 5 October 2012, under the heading "APPOINTMENT OF ADMINISTRATOR TO MANAGE A RESERVE TRUST", replace KATRINA HODGKINSON, M.P., Minister for Primary Industries and insert the words ANDREW STONER, M.P., Minister for Regional Infrastructure and Services.

ANDREW STONER, M.P.,
 Minister for Regional Infrastructure and Services

NOTIFICATION OF CLOSING OF A ROAD

IN pursuance of the provisions of the Roads Act 1993, the road hereunder described is closed and the lands comprised therein cease to be public road and the rights of passage and access that previously existed in relation to the road is extinguished. Upon closing, title to the land, comprising the former public road, vests in the body specified in the Schedule hereunder.

ANDREW STONER, M.P.,
 Minister for Regional Infrastructure and Services

Description

Parish – Newrybar; County – Rous;
Land District – Lismore; L.G.A. – Ballina

Road Closed: Lot 3, DP 1176329.

File No.: 07/3217.

Schedule

On closing, the land within Lot 3, DP 1176329 remains vested in the State of New South Wales as Crown Land.

Description

Parish – Ettrick; County – Rous;
Land District – Casino; L.G.A. – Kyogle

Road Closed: Lot 3, DP 1178483.

File No.: 12/01246.

Schedule

On closing, the land within Lot 3, DP 1178483 remains vested in the State of New South Wales as Crown Land.

Description

Parish – Ettrick; County – Rous;
Land District – Casino; L.G.A. – Kyogle

Road Closed: Lot 4, DP 1178483.

File No.: 12/01241.

Schedule

On closing, the land within Lot 4, DP 1178483 remains vested in the State of New South Wales as Crown Land.

MOREE OFFICE
Frome Street (PO Box 388), Moree NSW 2400
Phone: (02) 6752 5055 Fax: (02) 6752 1707

**REVOCATION OF RESERVATION OF CROWN
LAND**

PURSUANT to section 90 of the Crown Lands Act 1989, the reservation of Crown Land specified in Column 1 of the Schedule hereunder, is revoked to the extent specified opposite thereto in Column 2 of the Schedule.

ANDREW STONER, M.P.,
Minister for Regional Infrastructure and Services

SCHEDULE

<i>Column 1</i>	<i>Column 2</i>
Land District: Warialda. Local Government Area: Gwydir. Locality: North Star. Reserve No.: 96572. Public Purpose: Access. Notified: 4 February 1983. File No.: ME90 H 83.	The whole being Lot 24, DP No. 45257, Parish Booraba, County Stapylton, of an area of 31.67 hectares.

NEWCASTLE OFFICE

437 Hunter Street, Newcastle NSW 2300 (PO Box 2185, Dangar NSW 2309)

Phone: (02) 4925 4104 Fax: (02) 4925 3517

NOTIFICATION OF CLOSING OF A ROAD

IN pursuance of the provisions of the Roads Act 1993, the road hereunder described is closed and the lands comprised therein cease to be public road and the rights of passage and access that previously existed in relation to the road is extinguished. Upon closing, title to the land, comprising the former public road, vests in the body specified in the Schedule hereunder.

ANDREW STONER, M.P.,
Minister for Regional Infrastructure and Services

Description

*Parish – Mickibri; County – Kennedy;
Land District – Parkes; L.G.A. – Parkes*

Road Closed: Lots 1-2, DP 1178542.

File Nos: CL/00656 and 12/03280 NB.

Schedule

On closing, the land within Lots 1-2, DP 1178542 remain vested in the State of New South Wales as Crown Land.

Description

*Parish – Denman; County – Brisbane;
Land District – Muswellbrook; L.G.A. – Muswellbrook*

Road Closed: Lots 1-4, DP 1177309 (subject to easements for right of carriageway created by Deposited Plan 1177309).

File No.: 07/1147.

Schedule

On closing, the land within Lots 1-4, DP 1177309 remains vested in the State of New South Wales as Crown Land.

Description

*Parish – Urialla; County – Murray;
Land District – Braidwood; L.G.A. – Palerang*

Road Closed: Lot 1, DP 1177220.

File No.: GB07 H 105:BA.

Schedule

On closing, the land within Lot 1, DP 1177220 remains vested in the State of New South Wales as Crown Land.

Description

*Parish – Boco; County – Wellesley;
Land District – Cooma; L.G.A. – Cooma-Monaro*

Road Closed: Lot 1, DP 1177743.

File No.: 07/4582:BA.

Schedule

On closing, the land within Lot 1, DP 1177743 remains vested in the State of New South Wales as Crown Land.

Description

*Parish – Rose Valley; County – Beresford;
Land District – Cooma; L.G.A. – Cooma-Monaro*

Road Closed: Lot 1, DP 1178528.

File No.: GB06 H 586.

Schedule

On closing, the land within Lot 1, DP 1178528 remains vested in the State of New South Wales as Crown Land.

Description

*Parishes – Bowan and Toogong; County – Ashburnham;
Land District – Molong; L.G.A. – Cabonne*

Road Closed: Lot 1, DP 1177358.

File No.: OE05 H 134.

Schedule

On closing, the land within Part Lot 1, DP 1177358 remains vested in the State of New South Wales as Crown Land.

On closing, the land within Part Lot 1, DP 1177358 becomes vested in the State of New South Wales as Crown Land.

Council's Reference: KH:BIE.

Description

*Parish – Holywell; County – Durham;
Land District – Dungog; L.G.A. – Dungog*

Road Closed: Lot 100, DP 1176573 (subject to right of carriageway created by Deposited Plan 1176573).

File No.: 07/5300.

Schedule

On closing, the land within Lot 100, DP 1176573 remains vested in the State of New South Wales as Crown Land.

Description

*Parish – Bourke; County – Argyle
Land District – Goulburn; L.G.A. – Upper Lachlan Shire*

Road Closed: Lot 1, DP 1178108 (subject to easement for access created by Deposited Plan 1178108).

File No.: 11/13226.

Schedule

On closing, the land within Lot 1, DP 1178108 remains vested in the State of New South Wales as Crown Land.

Description

*Parish – Kember; County – King;
Land District – Boorowa; L.G.A. – Boorowa*

Road Closed: Lot 1, DP 1177417.

File No.: 07/5868:ER.

Schedule

On closing, the land within Lot 1, DP 1177417 remains vested in the State of New South Wales as Crown Land.

**NOTICE OF PUBLIC PURPOSE PURSUANT TO
SECTION 34A (2) (B) OF THE CROWN LANDS ACT
1989**

PURSUANT to section 34A(2)(b) of the Crown Lands Act 1989, the Crown reserve specified in Column 1 of the Schedule is to be occupied for the additional purpose specified in Column 2 of the Schedule.

ANDREW STONER, M.P.,
Minister for Regional Infrastructure and Services

SCHEDULE

Column 1

Reserve No.: 86018.
Public Purpose: Reservoir,
shire depot and storage.
Notified: 21 October 1966.
Parish: Trangie.
County: Narromine.

Column 2

Communication facilities.

NOWRA OFFICE
5 O’Keefe Avenue (PO Box 309), Nowra NSW 2541
Phone: (02) 4428 9100 Fax: (02) 4421 2172

NOTIFICATION OF CLOSING OF A ROAD

IN pursuance of the provisions of the Roads Act 1993, the road hereunder described is closed and the lands comprised therein cease to be public road and the rights of passage and access that previously existed in relation to the road is extinguished. Upon closing, title to the land, comprising the former public road, vests in the body specified in the Schedule hereunder.

ANDREW STONER, M.P.,
 Minister for Regional Infrastructure and Services

Description

*Parish – Pejar; County – Argyle;
 Land District – Crookwell; L.G.A. – Upper Lachlan*

Road Closed: Lot 6, DP 1166210.

File No.: 10/04359.

Schedule

On closing, the land within Lot 6, DP 1166210 remains vested in the State of New South Wales as Crown Land.

Description

*Parish – Bunyan; County – Beresford;
 Land District – Cooma; L.G.A. – Cooma-Monaro*

Road Closed: Lot 1, DP 1179137.

File No.: GB07 H 372.

Schedule

On closing, the land within Lot 1, DP 1179137 remains vested in the State of New South Wales as Crown Land.

Description

*Parish – Guineacor; County – Argyle;
 Land District – Goulburn; L.G.A. – Upper Lachlan Shire*

Road Closed: Lot 1, DP 1178499.

File No.: 07/5484.

Schedule

On closing, the land within Lot 1, DP 1178499 remains vested in the State of New South Wales as Crown Land.

ORANGE OFFICE
92 Kite Street (PO Box 2146), Orange NSW 2800
Phone: (02) 6391 4300 Fax: (02) 6362 3896

APPOINTMENT OF TRUST BOARD MEMBERS

PURSUANT to section 93 of the Crown Lands Act 1989, the persons whose names are specified in Column 1 of the Schedule hereunder, are appointed for the terms of office specified, as members of the trust board for the reserve trust specified opposite thereto in Column 2, which has been established and appointed as trustee of the reserve referred to opposite thereto in Column 3 of the Schedule.

ANDREW STONER, M.P.,
 Minister for Regional Infrastructure and Services

SCHEDULE

<i>Column 1</i>	<i>Column 2</i>	<i>Column 3</i>
Helen Mary BLACK (re-appointment).	Rydal Showground Trust.	Dedication No.: 590084. Public Purpose: Showground and public recreation. Notified: 8 June 1934. File No.: OE80 R 223.
Mark John YOUNG (new member).		
Joan PERRY (new member).		
Colin John HUNTER (re-appointment).		
Brett Morten RADBURN (re-appointment).		
Rachael Jodie YOUNG (re-appointment).		

Term of Office

For a term commencing this day and expiring 30 September 2017.

ROADS ACT 1993

ORDER

Transfer of Crown Road to Council

IN pursuance of the provisions of section 151, Roads Act 1993, the Crown public roads specified in Schedule 1 are transferred to the Roads Authority specified in Schedule 2 hereunder, as from the date of publication of this notice and as from that date, the roads specified in Schedule 1 cease to be Crown public roads.

ANDREW STONER, M.P.,
 Minister for Regional Infrastructure and Services

SCHEDULE 1

*Parish – Orange; County – Bathurst;
 Land District – Orange; Locality – Orange*

Roads shown highlighted by pink colour on diagram below.



SCHEDULE 2

Roads Authority: Orange City Council.

Crown Lands Reference: 12/06987.

Council Reference: D12/22600 102/301/150/1/1.

SYDNEY METROPOLITAN OFFICE
Level 12, Macquarie Tower, 10 Valentine Avenue, Parramatta 2150
(PO Box 3935, Parramatta NSW 2124)
Phone: (02) 8836 5300 Fax: (02) 8836 5365

ESTABLISHMENT OF RESERVE TRUST

PURSUANT to section 92(1) of the Crown Lands Act 1989, the reserve trust specified in Column 1 of the Schedules hereunder, is established under the name stated in that Column and is appointed as trustee of the reserve specified opposite thereto in Column 2 of the Schedules.

ANDREW STONER, M.P.,
 Minister for Regional Infrastructure and Services

SCHEDULE 1

<i>Column 1</i>	<i>Column 2</i>
Bundilla Forest (R43291) Reserve Trust.	Reserve No.: 43291. Public Purpose: Public recreation. Notified: 11 November 1908. File No.: 11/06638.

SCHEDULE 2

<i>Column 1</i>	<i>Column 2</i>
Hammers Road (R55439) Reserve Trust.	Reserve No.: 55439. Public Purpose: Public recreation. Notified: 26 May 1922. File No.: 11/06638.

SCHEDULE 3

<i>Column 1</i>	<i>Column 2</i>
Bell Bird Bend (R55445) Reserve Trust.	Reserve No.: 55445. Public Purpose: Public recreation. Notified: 26 May 1922. File No.: 11/06638.

SCHEDULE 4

<i>Column 1</i>	<i>Column 2</i>
Moxham Park (R83745) Reserve Trust.	Reserve No.: 83745. Public Purpose: Future public requirements. Notified: 2 March 1962. File No.: 11/06638.

SCHEDULE 5

<i>Column 1</i>	<i>Column 2</i>
Arrunga Gardens (R51125) Reserve Trust.	Reserve No.: 51125. Public Purpose: Access. Notified: 17 November 1915. File No.: 11/06638.

SCHEDULE 6

<i>Column 1</i>	<i>Column 2</i>
All Saints Cemetery (R60998) Reserve Trust.	Reserve No.: 60998. Public Purpose: Cemetery. Notified: 1 March 1929. File No.: 11/06638.

SCHEDULE 7

<i>Column 1</i>	<i>Column 2</i>
Eric Mobbs Memorial Park (R68581) Reserve Trust.	Reserve No.: 68581. Public Purpose: Public recreation. Notified: 18 August 1939. File No.: 11/06638.

APPOINTMENT OF CORPORATION TO MANAGE RESERVE TRUST

PURSUANT to section 95 of the Crown Lands Act 1989, the corporation specified in Column 1 of the Schedules hereunder, is appointed to manage the affairs of the reserve trust specified opposite thereto in Column 2, which is trustee of the reserve referred to in Column 3 of the Schedules.

ANDREW STONER, M.P.,
 Minister for Regional Infrastructure and Services

SCHEDULE 1

<i>Column 1</i>	<i>Column 2</i>	<i>Column 3</i>
Parramatta City Council.	Bundilla Forest (R43291) Reserve Trust.	Reserve No.: 43291. Public Purpose: Public recreation. Notified: 11 November 1908. File No.: 11/06638.

For a term commencing the date of this notice.

SCHEDULE 2

<i>Column 1</i>	<i>Column 2</i>	<i>Column 3</i>
Parramatta City Council.	Hammers Road (R55439) Reserve Trust.	Reserve No.: 55439. Public Purpose: Public recreation. Notified: 26 May 1922. File No.: 11/06638.

For a term commencing the date of this notice.

SCHEDULE 3

<i>Column 1</i>	<i>Column 2</i>	<i>Column 3</i>
Parramatta City Council.	Bell Bird Bend (R55445) Reserve Trust.	Reserve No.: 55445. Public Purpose: Public recreation. Notified: 26 May 1922. File No.: 11/06638.

For a term commencing the date of this notice.

SCHEDULE 4

<i>Column 1</i>	<i>Column 2</i>	<i>Column 3</i>
Parramatta City Council.	Eric Mobbs Memorial Park (R68581) Reserve Trust.	Reserve No.: 68581. Public Purpose: Public recreation. Notified: 18 August 1939. File No.: 11/06638.

For a term commencing the date of this notice.

SCHEDULE 5

<i>Column 1</i>	<i>Column 2</i>	<i>Column 3</i>
Parramatta City Council.	Arrunga Gardens (R51125) Reserve Trust.	Reserve No.: 51125. Public Purpose: Access. Notified: 17 November 1915. File No.: 11/06638.

For a term commencing the date of this notice.

SCHEDULE 6

<i>Column 1</i>	<i>Column 2</i>	<i>Column 3</i>
Parramatta City Council.	All Saints Cemetery (R60998) Reserve Trust.	Reserve No.: 60998. Public Purpose: Cemetery. Notified: 1 March 1929. File No.: 11/06638.

For a term commencing the date of this notice.

SCHEDULE 7

<i>Column 1</i>	<i>Column 2</i>	<i>Column 3</i>
Parramatta City Council.	Moxham Park (R83745) Reserve Trust.	Reserve No.: 83745. Public Purpose: Future public requirements. Notified: 2 March 1962. File No.: 11/06638.

For a term commencing the date of this notice.

ORDER – AUTHORISATION OF ADDITIONAL PURPOSE UNDER S121A

PURSUANT to s121A of the Crown Lands Act 1989, I authorise by this Order, the purpose specified in Column 1 to be an additional purpose to the declared purpose of the reserves specified opposite thereto in Column 2 of the Schedules.

ANDREW STONER, M.P.,
Minister for Regional Infrastructure and Services

SCHEDULE 1

<i>Column 1</i>	<i>Column 2</i>
Nature conservation.	Reserve No.: 43291. Public Purpose: Public recreation. Notified: 11 November 1908. File No.: 11/06638.

SCHEDULE 2

<i>Column 1</i>	<i>Column 2</i>
Nature conservation.	Reserve No.: 55439. Public Purpose: Public recreation. Notified: 26 May 1922. File No.: 11/06638.

SCHEDULE 3

<i>Column 1</i>	<i>Column 2</i>
Nature conservation.	Reserve No.: 55445. Public Purpose: Public recreation. Notified: 26 May 1922. File No.: 11/06638.

SCHEDULE 4

<i>Column 1</i>	<i>Column 2</i>
Public recreation.	Reserve No.: 51125. Public Purpose: Access. Notified: 17 November 1915. File No.: 11/06638.

SCHEDULE 5

<i>Column 1</i>	<i>Column 2</i>
Nature conservation.	Reserve No.: 83745. Public Purpose: Future public requirements. Notified: 2 March 1962. File No.: 11/06638.

SCHEDULE 6

<i>Column 1</i>	<i>Column 2</i>
Community purposes.	Reserve No.: 100123. Public Purpose: Boy scouts. Notified: 6 November 1987. File No.: 11/04515.

REVOCATION OF APPOINTMENT OF RESERVE TRUST

PURSUANT to section 92(3)(c) of the Crown Lands Act 1989, the appointment of the reserve trust specified in Column 1 of the Schedule hereunder, as trustee of the reserve(s), or part(s) of the reserve(s), specified opposite thereto in Column 2 of the Schedule, is revoked.

ANDREW STONER, M.P.,
Minister for Regional Infrastructure and Services

SCHEDULE

<i>Column 1</i>	<i>Column 2</i>
The Scout Association of Australia (NSW Branch).	Reserve No.: 100123. Public Purpose: Boy scouts. Notified: 6 November 1987. File No.: 11/04515.

NOTIFICATION OF CLOSING OF ROAD

IN pursuance of the provisions of the Roads Act 1993, the roads hereunder described are closed and the land comprised therein cease to be public roads and the rights of passage and access that previously existed in relation to the roads are extinguished. Upon closing, title to the land comprising the former public road vests in the body specified in the Schedule hereunder.

ANDREW STONER, M.P.,
Minister for Regional Infrastructure and Services

Description

*Parish – St Luke; County – Cumberland;
Land District – Metropolitan;
Local Government Area – Liverpool*

Road Closed: Lot 1, DP 1178808, at Mount Pritchard.
File No.: 11/06576.

Schedule

On closing, title for the land in Lot 1, DP 1178808, remains vested in Liverpool City Council as operational land.

ERRATUM

IN the notification appearing in the *New South Wales Government Gazette* of the 5 October 2012, Folio 4305, under the heading “Notification of Closing of Road” under Schedule it should read “On closing, title for the land in Lot 1, DP 1175450 remains vested in Woollahra Municipal Council as operational land”.

File No.: MN06 H 241.

ANDREW STONER, M.P.,
Minister for Regional Infrastructure and Services

TAMWORTH OFFICE**25-27 Fitzroy Street (PO Box 535), Tamworth NSW 2340****Phone: (02) 6764 5100 Fax: (02) 6766 3805****NOTIFICATION OF CLOSING OF A ROAD**

IN pursuance of the provisions of the Roads Act 1993, the road hereunder described is closed and the lands comprised therein cease to be public road and the rights of passage and access that previously existed in relation to the road is extinguished. Upon closing, title to the land, comprising the former public road, vests in the body specified in the Schedule hereunder.

ANDREW STONER, M.P.,
Minister for Regional Infrastructure and Services

Description

*Parish – Rodd; County – Pottinger;
Land District – Quirindi; L.G.A. – Liverpool Plains*

Road Closed: Lots 3 and 5, DP 1176523.

File No.: 10/00374.

Schedule

On closing, the land within Lots 3 and 5, DP 1176523 remains vested in the State of New South Wales as Crown Land.

Description

*Parish – Rodd; County – Pottinger;
Land District – Quirindi; L.G.A. – Liverpool Plains*

Road Closed: Lot 4, DP 1176523.

File No.: 10/00373.

Schedule

On closing, the land within Lot 4, DP 1176523 remains vested in the State of New South Wales as Crown Land.

Description

*Parish – Cuerindi; County – Darling;
Land District – Tamworth; L.G.A. – Tamworth Regional*

Road Closed: Lot 1, DP 1178557.

File No.: 08/7931.

Schedule

On closing, the land within Lot 1, DP 1178557 remains vested in the State of New South Wales as Crown Land.

Description

*Parish – Nundle; County – Parry;
Land District – Tamworth; L.G.A. – Tamworth Regional*

Road Closed: Lot 1, DP 1178472.

File No.: 07/1296.

Schedule

On closing, the land within Lot 1, DP 1178472 remains vested in the State of New South Wales as Crown Land.

Description

*Parishes – Lowe and Brennan;
Counties – Napier and Pottinger;
Land Districts – Coonabarabran and Gunnedah;
L.G.A. – Liverpool Plains, Warrumbungle*

Road Closed: Lots 1-2, DP 1178469 (subject to easement/
right of carriageway created by Deposited Plan 1178469).

File No.: 08/3291.

Schedule

On closing, the land within Lots 1-2, DP 1178469 remains vested in the State of New South Wales as Crown Land.

REVOCATION OF RESERVATION OF CROWN LAND

PURSUANT to section 90 of the Crown Lands Act 1989, the reservation of Crown Land specified in Column 1 of the Schedules hereunder, is revoked to the extent specified opposite thereto in Column 2 of the Schedules.

SCHEDULE 1*Column 1*

Land District: Tamworth.
Local Government Area:
Tamworth Regional.
Locality: North Tamworth.
Reserve No.: 753848.
Public Purpose: Future
public requirements.
Notified: 29 June 2007.
File No.: 12/07004.

Column 2

The part being Lot 62,
DP No. 1161239, Parish
Tamworth, County Inglis, of
an area of 1057 square metres.

SCHEDULE 2*Column 1*

Land District: Tamworth.
Local Government Area:
Tamworth Regional.
Locality: North Tamworth.
Reserve No.: 753848.
Public Purpose: Future
public requirements.
Notified: 29 June 2007.
File No.: 12/06992.

Column 2

The part being Lot 65,
DP No. 1161239, Parish
Tamworth, County Inglis, of
an area of 900 square metres.

SCHEDULE 3*Column 1*

Land District: Tamworth.
Local Government Area:
Tamworth Regional.
Locality: North Tamworth.
Reserve No.: 753848.
Public Purpose: Future
public requirements.
Notified: 29 June 2007.
File No.: 12/07009.

Column 2

The part being Lot 66,
DP No. 1161239, Parish
Tamworth, County Inglis, of
an area of 900 square metres.

TAREE OFFICE
98 Victoria Street (PO Box 440), Taree NSW 2430
Phone: (02) 6591 3500 Fax: (02) 6552 2816

NOTIFICATION OF CLOSING OF A ROAD

IN pursuance of the provisions of the Roads Act 1993, the road hereunder described is closed and the lands comprised therein cease to be public road and the rights of passage and access that previously existed in relation to the road is extinguished. Upon closing, title to the land, comprising the former public road, vests in the body specified in the Schedule hereunder.

ANDREW STONER, M.P.,
Minister for Regional Infrastructure and Services

Description

*Parish – Oxley; County – Macquarie;
Land District – Taree; L.G.A. – Greater Taree*

Road Closed: Lot 1, DP 1178487.

File No.: 07/3271.

Schedule

On closing, the land within Lot 1, DP 1178487 remains vested in the State of New South Wales as Crown Land.

WESTERN REGION OFFICE
45 Wingewarra Street (PO Box 1840), Dubbo NSW 2830
Phone: (02) 6883 5400 Fax: (02) 6884 2067

GRANTING OF A WESTERN LANDS LEASE

IT is hereby notified that under the provisions of section 28A of the Western Lands Act 1901, the Western Lands Leases of the lands specified in the following Schedule have been granted to the undermentioned persons.

The leases are subject to the provisions of the Western Lands Act 1901 and the Regulations thereunder.

The land is to be used only for the purpose of Residence.

Initial rent will be \$100.00 per annum and re-assessed thereafter annually on 1st April of each year.

The Conditions and Reservations annexed to such leases are those Conditions published in the *New South Wales Government Gazette* of 20 March, 2009, Folios 1416-1418.

All amounts due and payable to the Crown *must* be paid to the Department of Primary Industries, Crown Lands by the due date.

ANDREW STONER, M.P.,
Minister for Regional Infrastructure and Services

SCHEDULE

Administrative District – Walgett North; Shire – Walgett; Parish – Wallangulla/Mebea; County – Finch

WLL No.	Name of Lessee	File No.	Folio Identifier	Area (m ²)	Term of Lease	
					From	To
WLL 14761	Margaret WALFORD	WLL 14761	34/1076808	2490	10 October 2012	9 October 2032
WLL 15161	Noel NEMETH and Susan Joyce NEMETH	12/04376	52/1065215 and 34/1057617	2337	10 October 2012	9 October 2032

WITHDRAWAL OF LANDS FROM WESTERN LANDS LEASES

PURSUANT to section 35Q of the Western Lands Act 1901, the lands described in Column 1 of the Schedule hereunder, are withdrawn from the leases described in Column 2 of the Schedule for the purpose of being dedicated as public roads.

ANDREW STONER, M.P.,
Minister for Regional Infrastructure and Services

SCHEDULE

Descriptions

Counties – Cowper, Canbelego, Gregory and Clyde;
Administrative Districts – Bourke, Cobar, Brewarrina, Nyngan and Warren;
Shires of Bourke, Brewarrina and Bogan

Column 1 <i>Land Withdrawn from Lease (Lot/DP)</i>	Column 2 <i>Lease Affected by Withdrawal</i>	Column 3 <i>Title Affected</i>	Column 4 <i>Area Withdrawn from Lease (ha)</i>	Column 5 <i>Lease Area Following Withdrawal (ha)</i>
2/1173662	WLL 10513	4133/766638	27.93	507.8
6/1173662	WLL 555	6774/823889	149.0	4892
7/1173662	WLL 14212	6773/823889	19.52	368.8
9/1173662	WLL 1531	1/751866	53.81	1975
10/1173662	WLL 740	2/751866	51.99	1865
11/1173662 12/1173662 13/1173662 14/1173662	WLL 590	6717/820489 6771/822099 6772/822099 4803/768072	186.8	4649
15/1173662	WLL 12100	4804/768072	48.90	7962

<i>Column 1 Land Withdrawn from Lease (Lot/DP)</i>	<i>Column 2 Lease Affected by Withdrawal</i>	<i>Column 3 Title Affected</i>	<i>Column 4 Area Withdrawn from Lease (ha)</i>	<i>Column 5 Lease Area Following Withdrawal (ha)</i>
19/1173662 20/1173662	WLL 524	87/751852 6092/768950	41.22	3583
21/1173662	WLL 6705	3718/766131	124.0	11875
22/1173662 23/1173662	WLL 2559	578/761641 6076/768926	117.6	7774
24/1173662	WLL 656	6075/768926	44.73	4423
25/1173662	WLL 533	6073/768926	36.12	4399
26/1173662	WLL 754	6069/768926	36.81	4398
27/1173662	WLL 107	6071/768926	47.20	4468
30/1173662	WLL 3602	6798/823907	29.27	3228
31/1173662	WLL 14229	6797/823907	57.63	2844
34/1173662	WLL 3479	1363/763039	30.14	2423
35/1173662	WLL 1148	6011/768873	28.22	7511
36/1173662 37/1173662	WLL 3601	4956/768995	101.6	11147
38/1173662	WLL 1457	6060/768917	25.76	4118
39/1173662 41/1173662	WLL 113	6098/768954	50.32	4276
42/1173662	WLL 5613	3245/765450	30.88	1956
43/1173662	WLL 5612	3244/765449	6.007	2696
44/1173662	WLL 5755	3246/765451	31.27	1636
48/1173662	WLL 4176	2003/763927	25.72	1173
51/1173662	WLL 4177	2004/763928	18.93	990.0
52/1173662	WLL 8164	250/760965	22.09	4471
53/1173662	WLL 2032	251/760966	14.56	1018
54/1173662 56/1173662 57/1173662	WLL 2019	252/760967	19.58	1336

File No.: 11/11817.

DEDICATION OF CROWN LAND AS PUBLIC ROAD

PURSUANT to section 12 of the Roads Act 1993, the Crown Land described hereunder is, from the date of publication of this notice, dedicated as public road. The public road hereby dedicated is declared not to be Crown road within the meaning of the Roads Act 1993.

ANDREW STONER, M.P.,
Minister for Regional Infrastructure and Services

Descriptions

*Counties – Cowper, Canbelego, Gregory and Clyde;
Administrative Districts – Bourke, Cobar, Brewarrina,
Nyngan and Warren;
Shires of Bourke, Brewarrina and Bogan*

Lot 1, DP 1173662; Lot 2, DP 1173662; Lot 4, DP 1173662; Lot 5, DP 1173662; Lot 6, DP 1173662; Lot 7, DP 1173662; Lot 8, DP 1173662; Lot 9, DP 1173662; Lot 10, DP 1173662; Lot 11, DP 1173662; Lot 12, DP 1173662; Lot 13, DP 1173662; Lot 14, DP 1173662; Lot 15, DP 1173662; Lot 16, DP 1173662; Lot 18, DP 1173662; Lot 19, DP 1173662; Lot 20, DP 1173662; Lot 21, DP 1173662; Lot 22, DP 1173662; Lot 23, DP 1173662; Lot 24, DP 1173662; Lot 25, DP 1173662; Lot 26, DP 1173662; Lot 27, DP 1173662; Lot 28, DP 1173662; Lot 29, DP 1173662; Lot 30, DP 1173662; Lot 31, DP 1173662; Lot 32, DP 1173662; Lot 33, DP

1173662; Lot 34, DP 1173662; Lot 35, DP 1173662; Lot 36, DP 1173662; Lot 37, DP 1173662; Lot 38, DP 1173662; Lot 39, DP 1173662; Lot 40, DP 1173662; Lot 41, DP 1173662; Lot 42, DP 1173662; Lot 43, DP 1173662; Lot 44, DP 1173662; Lot 47, DP 1173662; Lot 48, DP 1173662; Lot 49, DP 1173662; Lot 51, DP 1173662; Lot 52, DP 1173662; Lot 53, DP 1173662; Lot 54, DP 1173662; Lot 56, DP 1173662 and Lot 57, DP 1173662.

Note: Affected parts of Crown Reserves 9262, 9263, 9264, 27279, 1103, 27278, 15973, 62059, 69427, 15974, 54, 27280, 27281, 4, 27283, 11331, 10383, 31090, 1013794 and 65481 are hereby revoked.

File No.: 11/11817.

APPOINTMENT OF CORPORATION TO MANAGE RESERVE TRUST

PURSUANT to section 95 of the Crown Lands Act 1989, the corporation specified in Column 1 of the Schedule hereunder, is appointed to manage the affairs of the reserve trust specified opposite thereto in Column 2, which is trustee of the reserve referred to in Column 3 of the Schedule.

ANDREW STONER, M.P.,
Minister for Regional Infrastructure and Services

SCHEDULE

<i>Column 1</i>	<i>Column 2</i>	<i>Column 3</i>
Mothers Ancestral Guardians Indigenous Corporation.	Byrock Rock Holes Reserve Trust.	Reserve No.: 1004509. Public Purpose: Public recreation. Notified: 11 April 2003. File No.: WL05 R 10.

For a term commencing the date of this notice and expiring 11 October 2017.

ORDER – AUTHORISATION OF ADDITIONAL PURPOSE UNDER S121A

PURSUANT to s121A of the Crown Lands Act 1989, I authorise by this Order, the purpose specified in Column 1 to be an additional purpose to the declared purpose of the reserves specified opposite thereto in Column 2 of the Schedule.

ANDREW STONER, M.P.,
Minister for Regional Infrastructure and Services

SCHEDULE

<i>Column 1</i>	<i>Column 2</i>
Urban services.	Dedication No.: 630006. Public Purpose: Public hall. Notified: 21 December 1928. File No.: WL0 3 R32.

Other Notices

ANTI-DISCRIMINATION ACT 1977 (NSW)

Exemption Order

UNDER section 126 of the Anti-Discrimination Act 1977, a temporary exemption from the operation of sections 7, 8, 51 and 52 of the Anti-Discrimination Act 1977, is granted to the University of Technology, Sydney (UTS) and the University of Western Sydney (UWS) (the Applicant) in order to advertise and employ 72 testers of Anglo-Australian, Muslim Australian of Middle Eastern and Indian ethnic origins to assist in the conduct of a research project entitled 'Ethnic Discrimination in the private rental market' in New South Wales.

This exemption is granted on the following conditions:

1. No lease undertakings will be given by the testers and no lease agreements for rental property will be entered into by the rental testers;
2. No false references will be provided for the rental testers;
3. The Applicant is to provide to the Anti-Discrimination Board of New South Wales (the Board) a copy of the transcript that the testers will be using before the research commences;
4. The Applicant will consult with the Real Estate Institute of Australia, NSW and the Property Owners Association of New South Wales before the research commences; and
5. The Applicant is to provide the Board a report at the end of the research on the process of the research and its outcomes.

Dated this 5th day of October 2012.

STEPAN KERKYASHARIAN, A.O.,
President,
Anti-Discrimination Board of NSW

APPRENTICESHIP AND TRAINEESHIP ACT 2001

NOTICE is given that the Commissioner for Vocational Training has made Vocational Training Orders for the recognised traineeship vocations of:

- Transport and Logistics – Rail Networking Control
- Transport and Logistics – Rail Signalling
- Transport and Logistics – Track Protection

under section 6 of the Apprenticeship and Traineeship Act 2001.

The Orders specify a number of matters relating to the required training for these vocations including the term/s of traineeships, probationary period/s and qualifications to be undertaken.

The orders will take effect from the date of publication in the NSW Government Gazette.

A copy of the Orders may be inspected at any State Training Services Regional Office of the Department of Education and Communities or on the internet at: https://www.training.nsw.gov.au/cib_vto/cibs/cib_558.html

CO-OPERATIVES ACT 1992

Notice under Section 601AA of the
Corporations Act 2001 as Applied by
Section 325 of the Co-operatives Act 1992

NOTICE is hereby given that the co-operative mentioned below will be deregistered when two months have passed since the publication of this notice:

ROCKDALE YOUTH COMMUNITY CENTRE
CO-OPERATIVE LIMITED – NSWC00186

Dated this 5th day of October 2012.

R. LUNNEY,
Delegate of the Registrar of Co-Operatives

CO-OPERATIVES ACT 1992

Notice under Section 601AB of the
Corporations Act 2001 as Applied by
Section 325 of the Co-operatives Act 1992

NOTICE is hereby given that the co-operative mentioned below will be deregistered when two months have passed since the publication of this notice:

NEW ENGLAND GOURMET RABBIT
CO-OPERATIVE LTD – NSWC05067

Dated this 5th day of October 2012 at Bathurst.

R. LUNNEY,
Delegate of the Registrar of Co-Operatives

CO-OPERATIVES ACT 1992

Notice under Section 601AB of the
Corporations Act 2001 as Applied by
Section 325 of the Co-operatives Act 1992

NOTICE is hereby given that the co-operative mentioned below will be deregistered when two months have passed since the publication of this notice:

FIDELITY-ST. GEORGE ADMINISTRATION
CO-OPERATIVE LIMITED

Dated this 5th day of October 2012 at Bathurst.

R. LUNNEY,
Delegate of the Registrar of Co-Operatives

ELECTRICITY SUPPLY ACT 1995

Invitation to Comment

Application for Electricity Retail Supplier Licence

IPART has received an application for an electricity retail supplier's licence under the Electricity Supply Act 1995 from OzGen Retail Pty Ltd (ABN 22 129 658 206) to operate in New South Wales.

IPART seeks public submissions on this application. Submissions should address the assessment criteria contained in the Electricity Supply Act.

A copy of this application can be viewed and downloaded from IPART's website at www.ipart.nsw.gov.au

All submissions should reach IPART by COB 27 November 2012. Please direct all enquiries to Ms Carly Price on (02) 9113 7732.

Dated: 12 October 2012.

FIONA TOWERS,
Acting Chief Executive Officer,
Independent Pricing and Regulatory Tribunal
PO Box Q290,
QVB Post Office NSW 1230

ELECTRICITY SUPPLY ACT 1995

Invitation to Comment

Application for Electricity Retail Supplier Licence

IPART has received an application for an electricity retail supplier's licence under the Electricity Supply Act 1995 from Powershop Australia Pty Ltd (ABN 41 154 914 075) to operate in New South Wales.

IPART seeks public submissions on this application. Submissions should address the assessment criteria contained in the Electricity Supply Act.

A copy of this application can be viewed and downloaded from IPART's website at www.ipart.nsw.gov.au

All submissions should reach IPART by COB 27 November 2012. Please direct all enquiries to Ms Carly Price on (02) 9113 7732.

Dated: 12 October 2012.

FIONA TOWERS,
Acting Chief Executive Officer,
Independent Pricing and Regulatory Tribunal
PO Box Q290,
QVB Post Office NSW 1230

ELECTRICITY SUPPLY ACT 1995

Invitation to Comment

Application for Electricity Retail Supplier Licence

IPART has received an application for an electricity retail supplier's licence under the Electricity Supply Act 1995 from Click Energy Pty Ltd (ABN 41 116 567 492) to operate in New South Wales.

IPART seeks public submissions on this application. Submissions should address the assessment criteria contained in the Electricity Supply Act.

A copy of this application can be viewed and downloaded from IPART's website at www.ipart.nsw.gov.au

All submissions should reach IPART by COB 27 November 2012. Please direct all enquiries to Ms Carly Price on (02) 9113 7732.

Dated: 12 October 2012.

FIONA TOWERS,
Acting Chief Executive Officer,
Independent Pricing and Regulatory Tribunal
PO Box Q290,
QVB Post Office NSW 1230

GAS SUPPLY ACT 1996

Invitation to Comment

Application for Natural Gas Retail Supplier Authorisation

IPART has received an application for a natural gas retail supplier's authorisation under the Gas Supply Act 1996 from ERM Power Retail Pty Ltd (ABN 87 126 175 460) to operate in New South Wales.

IPART seeks public submissions on this application. Submissions should address the assessment criteria contained in the Gas Supply Act.

A copy of this application can be viewed and downloaded from IPART's website at www.ipart.nsw.gov.au

All submissions should reach IPART by COB 27 November 2012. Please direct all enquiries to Ms Carly Price on (02) 9113 7732.

Dated: 12 October 2012.

FIONA TOWERS,
Acting Chief Executive Officer,
Independent Pricing and Regulatory Tribunal
PO Box Q290,
QVB Post Office NSW 1230

GEOGRAPHICAL NAMES ACT 1966

Notice of Discontinuance of School Names

PURSUANT to the provisions of section 14 of the Geographical Names Act 1966, the Geographical Names Board hereby notifies that it has this day DISCONTINUED the school names listed below:

- 'Clandulla Public School', assigned 12 December 1986, Folio 4465,
- 'Kirkconnell Public School', assigned 16 August 1974, Folio 4078,
- 'Dubbo Base Hospital Public School,' assigned 22 June 1979, Folio 3573,
- 'Spicers Creek Public School', assigned 18 June 1976, Folio 9858,
- 'Mandagery Public School', assigned 17 November 1978, Folio 8941.

The position and extent for these features are recorded and shown in the Geographical Names Register of New South Wales, which can be viewed on the Geographical Names Board internet site at www.gnb.nsw.gov.au

K. RICHARDS,
Acting Secretary

Geographical Names Board,
PO Box 143,
Bathurst NSW 2795

LAND TAX MANAGEMENT ACT 1956

Land Tax Threshold

THIS determination of the land tax threshold is made under section 62TBA of the Land Tax Management Act 1956.

Indexation Factor

It is hereby notified that pursuant to section 62TBB (3) of the Land Tax Management Act 1956, -0.306% has been

determined as the percentage by which average land values of land within residential, commercial and industrial zones have changed between 1 July 2011 and 1 July 2012. The indexation factor is determined at 0% for the 2013 land tax year.

Indexed Amount

It is hereby notified that pursuant to section 62TBA (7) (a) of the Land Tax Management Act 1956 that \$408,000 is the determined indexed amount for the 2013 land tax year.

Average of Indexed Amounts

It is hereby notified that pursuant to section 62TBA (7) (b) of the Land Tax Management Act 1956 that the average of the indexed amounts pursuant to section 62TBA (7) (b) is \$406,000; and the indexed amounts used to calculate that average amount are:

For the 2011 land tax year \$401,000

For the 2012 land tax year \$408,000

For the 2013 land tax year \$408,000

Determination of the Tax Threshold

Under section 62TBA (2) of the Land Tax Management Act 1956, the tax threshold for the 2013 land tax year is the average of the indexed amounts \$406,000 or the \$396,000 tax threshold for the 2012 land tax year, whichever is the greater.

It is hereby notified that pursuant to section 62TBA (7) (c) of the Land Tax Management Act 1956, that the amount of \$406,000 has been determined as the tax threshold for the 2013 land tax year.

Determination of the Premium Rate Threshold

Under section 62TBC (2) of the Land Tax Management Act 1956, the premium rate threshold for the 2012 land tax year is \$2,421,000.

The land tax threshold for the 2012 land tax year is \$396,000.

The land tax threshold for the 2013 land tax year under section 62TBA (7) (c) as determined above is \$406,000.

It is hereby notified that pursuant to section 62TBC (4) of the Land Tax Management Act 1956, that the amount of \$2,482,000 has been determined as the premium rate threshold for the 2013 land tax year.

PHILIP WESTERN,
Valuer General

LEGAL PROFESSION ADMISSION RULES 2005

Amendments to Fourth Schedule

AT its meeting on 2 October 2012 the Legal Profession Admission Board resolved to amend the Fourth Schedule to the Legal Profession Admission Rules 2005 as follows:

1. *Delete* 'College of Law: Professional Program' and *insert* 'College of Law: The Practical Legal Training Program'
2. *Delete* 'University of Technology Sydney: Faculty of Law Professional Program OR Master of Law and Legal Practice' and *insert* 'University of Technology Sydney: Graduate Diploma in Legal Practice OR Graduate Certificate in Legal Practice OR Master of Law and Legal

Practice OR Graduate Certificate in Professional Legal Practice'.

Dated: 8 October 2012.

ROBIN SZABO,
Executive Officer,
Legal Profession Admission Board

LOCAL GOVERNMENT ACT 1993 – PROCLAMATION

Marie Bashir, A.C., C.V.O., Governor

I, Professor Marie Bashir, A.C., C.V.O., Governor of the State of New South Wales, with the advice of the Executive Council, and in pursuance of section 218B of the Local Government Act 1993, hereby alter the boundaries of the Area of Yass Valley as described by Proclamation in *NSW Government Gazette* No. 169 of 16 November 2007, and the Area of Harden Shire as described by Proclamation in *NSW Government Gazette* No. 130 of 19 November 1999, by transferring part of the Area of Yass Valley described in Schedule A hereto and adding it to the Area of Harden Shire so that the boundary of the Area of Yass Valley and the boundary of the Area of Harden Shire shall be as described in Schedules B and C hereto.

Signed and sealed at Sydney, this 26th day of September 2012.

By Her Excellency's Command,

DON PAGE, M.P.,
Minister for Local Government

GOD SAVE THE QUEEN!

SCHEDULE A

Areas to be transferred

Area about 159 hectares: Being Lot 24, DP 748158; Lot 350, DP 753595 and Lot 7306, DP 1153126

SCHEDULE B

Yass Valley (as altered)

Area about 4087.74 square kilometres. Commencing at the intersection of the Murrumbidgee River and the boundary between the State of New South Wales and the Australian Capital Territory, near Cusacks Crossing; and bounded thence by that boundary, generally south-westerly to the source of Fastigata Creek; by a line westerly to Webbs Ridge; by that ridge generally north-easterly to the north-eastern corner of Lot 3, DP 751811; by part of the eastern boundary of Lot 4, DP 751811 northerly to the western prolongation of the east most northern boundary of the Parish of Cooree, County of Cowley; by that prolongation westerly to the eastern boundary of Lot 40, DP 750980; by part of that boundary and the southern boundary of that lot, southerly and westerly, part of the eastern and the southern boundaries of Lot 36, DP 750980, southerly and westerly, the southern boundary of Portion 19, Parish of Weejasper, County of Buccleuch; by the southern boundary of that portion, part of an eastern and the southernmost boundary of Portion 27, and the southern boundary of Portion 26, easterly, southerly and again westerly to the south-western corner of the said Portion 26; by the generally western boundary of the Parish of Weejasper, generally northerly, the generally south-eastern boundary of Lot 1, DP 651929, generally north-easterly and

the generally western boundary of the West Goodradigbee, generally northerly to the Murrumbidgee River; by that river downwards to the generally western boundary of the Parish of Talmo, County of Harden; by part of that boundary generally northerly, the western, southern and eastern boundaries of Lot A, DP 358100 southerly, easterly and northerly, again the generally western boundary of the Parish of Talmo generally northerly to the north-western corner of Portion 96; by the southernmost western boundary of Portion 347, Parish of Bookham and the former generally western boundary of that Parish generally northerly to the Hume Highway, easterly to the southerly prolongation of the generally eastern boundary of Lot 7306 DP 1153126, northerly, by the generally eastern boundary of the aforesaid lot and Lot 350 DP 753595, generally north-westerly to the southern prolongation of the generally eastern boundary of Lot 24 DP 748158, by that line and the generally eastern boundary of that lot, generally northerly and westerly to the road forming part of the western boundary of Portion 344; by that road, part of the generally western boundary of that Parish and part of the generally western boundary of the Parish of Mylora generally northerly to the north-western corner of Portion 201; by part of the northern boundary of that Portion easterly to its intersection with a line along the western boundary of Portion 189; by that line and that boundary, and part of the southern and the western boundaries of Portion 80, northerly, westerly and again northerly to Jugiong Creek; by that creek downwards to the generally western boundary of the Parish of Mylora; by part of that boundary northerly, the southern, the western and part of the northern boundaries of Lot 102, DP 753618 westerly, northerly and easterly, the generally western and generally north-western boundaries of the Parish of Binalong generally northerly and generally north-easterly, part of the generally western boundary of the Parish of Eubindal, generally northerly to the range forming the generally south-western watershed of the Boorowa River; by that range generally south-easterly, the range forming the generally south-western watershed of Blakney Creek, generally south-easterly, Muntoonen range, generally south-easterly, to the generally northern boundary of Lot 1, DP 1002800; by part of that boundary, generally westerly, the western boundary of that lot and the generally south-western boundary of Lot 2, DP 245337, southerly and generally south-easterly to again the Muntoonen Range; by part of that range, generally south-easterly to the western boundary of Lot 1, DP 1024315; by part of that boundary and the southern boundary of that lot, southerly and easterly, the generally western and northern boundaries of Lot 2, DP 1024315, generally northerly and easterly, part of the western boundary of Lot 1, DP 859196 and its prolongation, northerly, part of the generally south-eastern boundary of Lot 3, DP 1024315, generally north-easterly, the northern boundary of Lot 1, DP 859196 and its prolongation, easterly, the generally western boundaries of Lot 198 and 203, DP 754113 and Lot 225, DP 754132, generally southerly, the generally western and southern boundaries of Lot 209, DP 754132, generally southerly and easterly, the generally southern and part of the eastern boundaries of Lot 214, DP 754132, generally easterly and northerly, the southern boundary of Lot 223, DP 754132, easterly and the western and generally northern boundaries of Lot 61, DP 133825, northerly and generally easterly to the generally western side of Gundaroo Road; by that side of that road, generally northerly to the south-western prolongation of the generally south-eastern boundary of Lot 1, DP 815493; by that prolongation, boundary and the eastern boundary of that lot, generally north-easterly and northerly, part of the generally

south-western boundary of Lot 181, DP 754127, generally south-easterly, the generally north-eastern boundary of Lot 227, DP 754132, generally south-easterly, the western boundary of Lot 1, DP 594328, southerly, part of the northern, the western and the generally south-western boundaries of Lot 180, DP 754127 and its prolongation, westerly, southerly and generally south-easterly, part of the generally western, the northern and part of the generally eastern boundaries of Lot 84, DP 754127, generally northerly, easterly and southerly, part of the generally northern, generally western and southern boundaries of Lot 83, DP 754127 and its prolongation, westerly, generally southerly and easterly, part of the western boundary of Lot 81, DP 754127 northerly, a line, the western boundaries of Lots 110 and 165, DP 754127, northerly, the western and northern boundaries of Lot 105, DP 754127, northerly and easterly, the northern and part of the eastern boundaries of Lot 106, DP 754127, easterly and southerly, part of the generally northern and the eastern boundaries of Lot 111, DP 754127 and its prolongation, easterly and southerly, part of the northern and the generally eastern boundaries of Lot 81, DP 754127, easterly and generally southerly, the generally south-eastern boundary of Lot 159, DP 754127, generally north-easterly, the generally northern boundary of Lot 31, DP 754132, generally easterly, a line north-easterly, the generally south-eastern boundaries of Lot 18, DP 754883 and Lot 122, DP 618106, generally north-easterly, part of the eastern boundary of Lot 122, DP 618106, the eastern boundary of Lot 59, DP 750008, again, part of the eastern boundary of Lot 122, DP 618106 and its prolongation, northerly to the road from Gunning to Collector; by that road, generally easterly to the northern prolongation of the western boundary of Lot 13, DP 750008; by that prolongation, boundary and the southern boundary of that lot and its prolongation, southerly and easterly to the Federal Highway; by that highway, generally south-westerly to the to the generally north-eastern boundary between the State of New South Wales and the Australian Capital Territory; by that boundary, and the north-western, aforesaid, boundary, generally north-westerly and south-westerly to the point of commencement.

SCHEDULE C

Harden Shire (as altered)

Area about 1863.54 square kilometres. Commencing at the junction of the southern prolongation of the generally western boundary of the Parish of Talmo, County of Harden and the Murrumbidgee River: and bounded thence by that prolongation and part of that boundary generally northerly, the western, southern and eastern boundaries of Lot A, DP 358100 southerly, easterly and northerly, again the generally western boundary of the Parish of Talmo generally northerly to the north-western corner of Portion 96; by the southernmost western boundary of Portion 347, Parish of Bookham and the former generally western boundary of that Parish generally northerly to the Hume Highway, easterly to the southerly prolongation of the generally eastern boundary of Lot 7306, DP 1153126, northerly, by the generally eastern boundary of the aforesaid lot and Lot 350, DP 753595, generally north-westerly to the southern prolongation of the generally eastern boundary of Lot 24, DP 748158, by that line and the generally eastern boundary of that lot, generally northerly and westerly to the road forming part of the western boundary of Portion 344; by that road, part of the generally western boundary of that Parish and part of the generally western boundary of the Parish of Mylora generally northerly to the north-western corner of Portion 201; by part of the

northern boundary of that Portion easterly to its intersection with a line along the western boundary of Portion 189; by that line and that boundary, and part of the southern and the western boundaries of Portion 80, northerly, westerly and again northerly to Jugiong Creek; by that creek downwards to the generally western boundary of the Parish of Mylora; by part of that boundary northerly, the southern, the western and part of the northern boundaries of Lot 102, DP 753618 westerly, northerly and easterly, again the generally western and generally north-western boundaries of the Parish of Binalong generally northerly and generally north-easterly, the generally north-eastern boundaries of the Parishes of Bobbara, Nuring and Douglas generally north-westerly, part of the generally northern boundary of the Parish of Moppity generally westerly, the east most eastern and the generally southern boundaries of Portion 217 of that Parish southerly and generally westerly, again the generally northern boundary of the Parish of Moppity generally westerly, the generally north-western boundary of the Parish of Wilkie and part of the generally north-western boundary of the Parish of Nubba generally south-westerly, to the south-western corner of Portion 20 of the last-mentioned parish; by the southern boundary of that portion and Portion 132 and part of the southern boundary of Portion 19 easterly to the northernmost north-eastern corner of Portion 73; by an eastern boundary of that portion southerly to the south-western corner of Portion 119; by a line along the southern boundary of that portion and a southern boundary of Portion 118 easterly to a western boundary of the latter portion; by a line along that boundary and the western boundary of Portion 48 southerly to the south-western corner of the latter portion; by the southern boundary and part of the eastern boundary of the said Portion 48 easterly and northerly to the westernmost south-western corner of Portion 49; by boundaries of that portion easterly, northerly, again easterly, southerly, and again easterly to the south-western corner of Portion 43; by a line along the southern boundary of that portion easterly; by the reserved road through Portion 62 south-easterly to the road catalogued R.5893-1603R at the Lands Department, Sydney; by a line along the middle of that road generally southerly to the southern boundary of Portion 65, Parish of Wallendoon; by a line along the middle of the road forming the western boundary of Portion 212 southerly to the road from Wallendbeen to Murrumburrah; by that road south-easterly to the north-eastern corner of Portion 54; by the eastern boundary of that portion and part of the northern boundary of Portion 307 southerly and easterly to the north-eastern corner of the last-mentioned portion; by the south-eastern and southern boundaries of that portion and the southernmost boundary of Portion 324 south-westerly and westerly; by the western boundary of Portion 190 southerly to Connaughtmans Creek; by that creek downwards to the north-eastern corner of Portion 112, Parish of Demondrille; by a line along the eastern boundary of that portion and part of the eastern boundary of Portion 113 southerly to the south-western corner of Portion 171; by the southern boundary of that portion and Portion 160 easterly; by a line and the eastern boundary of Portion 551, Parish of Cullinga, southerly by the southern boundary of that portion and part of the southern boundary of Portion 552 westerly to the north-western corner of Portion 617; by part of the western boundary of that portion southerly to the north-eastern corner of Portion 306; by the northern boundary of that portion and Portion 176 westerly; by part of the western boundary of that portion southerly to the south-eastern corner of Portion 691; by the road forming the northern boundary of Portion 317 westerly to the south-eastern corner of Portion

504; by the eastern, northern, and western boundaries of that portion northerly, westerly and southerly; by part of the northern boundary of Portion 173 easterly to the north-eastern corner of that portion; by the eastern and part of the southern boundary of the said Portion 173 southerly and westerly to the easternmost north-eastern corner of Portion 502; by the easternmost and southernmost boundaries of that portion southerly and westerly; by part of the eastern and part of the southern boundary of Portion 501 southerly and westerly to the north-eastern corner of Portion 45; by the eastern boundary of that portion southerly; by part of the northern boundary of Portion 178 easterly to the south-western corner of Portion 500; by the western northern, and eastern boundaries of that portion and part of the eastern boundary of Portion 178 northerly, easterly and southerly to the westerly prolongation of the northern boundary of Portion 508; by a line along the northern and part of the eastern boundary of that portion easterly and southerly to the southwestern corner of Portion 318; by the southern boundary of that portion and a line easterly to the western boundary of Portion 11; by part of that boundary, a western, a northern, and the westernmost boundaries of Portion 240, southerly, westerly, and again southerly; by part of the northern and part of the western boundary of Portion 340 westerly and southerly to the north-eastern corner of Portion 222; by the northern and western boundaries of that portion, the western and southern boundaries of Portion 224 and the southern boundary of Portion 225 westerly, southerly and easterly; by the western boundary of Portion 343, the western, southern and eastern boundaries of Portion 348 and the southern and eastern boundaries of Portion 344 southerly, easterly, northerly, again easterly, and again northerly to the westerly prolongation of the northernmost boundary of Portion 660; by a line along that boundary easterly to the northernmost north-eastern corner of that portion; by the easternmost boundary of the said Portion 660 southerly to the south-western corner of Portion 119; by part of the southern boundary of that portion easterly to the easternmost north-eastern corner of the land comprised in Certificate of Title, Volume 5, 740. Folios 7 and 8; by the easternmost boundary of that land southerly to the northern boundary of Portion 590; by part of the northern boundary and a line along the western boundary of that portion westerly and southerly to the northern boundary of Portion 116; by part of that boundary westerly to the eastern boundary of Portion 124; by part of that boundary northerly to the north-eastern corner of that portion; by a line along the northern boundary of the said Portion 124 westerly to the eastern boundary of Portion 121; by a line along part of that boundary and the eastern boundary of portions 123 and 621 and the easternmost boundary of Portion 690 southerly to the northern boundary of Portion 671; by a line along part of the northern boundary of that portion and the northern boundary of Portion 96 easterly to the north-eastern corner of the latter portion; by part of the eastern boundary of the said Portion 96 southerly to the north-western corner of Portion 653; by a line along the northern boundary of that portion easterly to the westernmost north-western corner of Portion 142; by a line along the westernmost boundary of Portion 142 and the western boundary of Portions 570, 569, 568, 573, 572 and 666 southerly to the south-western corner of the last-mentioned portion; by the southern and eastern boundaries of the said Portion 666 and part of the eastern boundary of Portion 572, easterly and northerly to the south-western corner of Portion 571; by the southernmost, and eastern and a southern boundary of the said Portion 571; easterly, northerly and again easterly to the easternmost south-eastern

corner of that portion; by the boundaries of Demondrille Shire as described in *NSW Government Gazette* of 29th November, 1935, the north-eastern corner of Portion 76 Rem., Parish of Cooney; by part of the generally north-eastern boundary of that parish generally south-easterly to the north-eastern corner of Portion 26; by Cooneys Creek downward to Murrumbidgee River, aforesaid, by that river upwards to the north-western corner of Portion 56, Parish of Bundarbo, County of Buccleuch; by the northern boundary of that portion easterly to the Murrumbidgee River, aforesaid, and by that river upwards to the point of commencement.

LOCAL GOVERNMENT ACT 1993 – PROCLAMATION

Marie Bashir, A.C., C.V.O., Governor

I, Professor Marie Bashir, A.C., C.V.O., Governor of the State of New South Wales, with the advice of the Executive Council, and in pursuance of section 218B of the Local Government Act 1993, hereby alter the boundaries of the Area of Inverell Shire and the Area of Guyra Shire as described by Proclamation in *NSW Government Gazette* No. 73 of 27 April 2001, by transferring part of the Area of Inverell Shire described in Schedule A hereto and adding it to the Area of Guyra Shire so that the boundary of the Area of Inverell Shire and the boundary of the Area of Guyra Shire shall be as described in Schedules B and C hereto.

Signed and sealed at Sydney, this 26th day of September 2012.

By Her Excellency's Command,

DON PAGE, M.P.,
Minister for Local Government

GOD SAVE THE QUEEN!

SCHEDULE A

Area to be transferred

Area about 33.02 hectares. Being Lot 59, DP 753678 and that part of Lot 23, DP 753678, lying in Inverell Shire.

SCHEDULE B

Inverell Shire (as altered)

Area about 8634.1 square kilometres: Commencing at the confluence of the Macintyre River with the Dumaresq River on the boundary dividing the States of New South Wales and Queensland; and bounded thence by that boundary generally easterly and southeasterly to the confluence of Beardy River or Glen Creek with the Dumaresq River; by the said Beardy River or Glen Creek upwards to Swamp Oak Creek; by that creek upwards to the easternmost northeastern corner of portion 31, Parish of Astley, County of Arrawatta; by the easternmost boundary of that portion and the eastern boundary of portion 1, southerly; by a line southeasterly to the north-western corner of portion 1, Parish of Strathbogie, County of Gough; by the western boundary of that portion southerly; by a line south for a distance of about 4 224.5 metres (210 chains) to the generally western boundary of T.S. and C.R. 61 731 notified 14th March, 1930; by part of the generally southwestern boundary of the Parish of Gordon generally southeasterly to the southwestern corner of portion 68; by the ridge dividing the waters of Arrawatta Creek and Stoney Creek passing through portions 38 and 39, Parish of Vivier, County of Arrawatta, generally southerly to the

northernmost north-eastern corner of portion 34, Parish of Vivier, by the south-western boundary of portion 39, Parish of Vivier, southeasterly to the southernmost southwestern corner of that portion; by part of the generally eastern boundary of that parish and part of the generally eastern boundary of the Parish of Buckley generally southerly to the northern boundary of Portion 131, Parish of Wellingrove, County of Gough; by part of that boundary easterly to a line along the western boundary of portion 96; by that line southerly to its intersection with a line along the northern boundary of portion 197, Parish of Buckley, County of Arrawatta; by that line westerly to the said generally eastern boundary of that parish; by that boundary generally southerly to the northeastern corner of portion 124, Parish of Balaclava, County of Gough; by the generally northern and part of the generally eastern boundaries of that parish generally easterly and southerly to the southernmost south-western corner of portion 134, Parish of Waterloo, by part of the generally northeastern boundary of cancelled portion 144 (shown in plan catalogued G. 5074 1761) generally south-easterly; by the range dividing the waters of The Falls and Little Oak Creek and the Waterloo Range generally southerly to the ridge forming the generally southern watershed of the headwaters of the Macintyre River; by that ridge generally westerly to the eastern boundary of Lot 2, DP 786388; by part of that boundary, part of the generally south-western boundary of that Lot southerly and generally north-westerly, the generally south-eastern boundary of Lot 1, DP 786388 south-westerly, a line south-easterly and part of the generally south-western boundary of Lot 3, DP 786388 generally south-easterly to the generally southern boundary of the County of Gough; by part of that boundary generally westerly to the western boundary of Lot 1, DP 841482; by part of that boundary southerly to again the ridge forming the generally southern watershed of the headwaters of the Macintyre River; by part of that ridge generally north-westerly to the eastern boundary of Portion 115, Parish of Eden, County of Clarke; by part of that boundary, the southern and part of the western boundaries of that portion southerly, westerly and northerly to again, the ridge forming the generally southern watershed of the headwaters of the Macintyre River; by that ridge generally westerly to a point on the westernmost western boundary of portion 62, Parish of Eden, about 402.34 metres (20 chains) south of the westernmost northwestern corner of that portion; by part of that boundary northerly to the westernmost northwestern corner of that portion; by part of the generally southwestern boundary of the Parish of Eden, generally north-westerly, the eastern and southern boundaries of portion 11, Parish of Single, County of Hardinge, southerly and westerly, the generally eastern and southern boundaries of portion 35, generally southerly and westerly to Copes Creek; by that creek downwards to the southern prolongation of the generally western boundary of portion 10; by that boundary and the generally western boundary of portion 9, generally northerly, again the generally southwestern boundary of the Parish of Eden, generally northwesterly the northern boundary of Portion 29, Parish of Single westerly, a line north-westerly to the eastern most corner of Lot 3, DP 588622; by the generally north-eastern boundary of that lot generally north-westerly, the northern boundary of Lot 2, DP. 588622 westerly, the northern and part of the western boundaries of Lot 1, DP 588622 westerly and southerly to the generally northern boundary of the County of Hardinge; by part of that boundary generally westerly to the northern prolongation of the eastern boundary of portion 262, Parish of Swinton, County of Hardinge; by that prolongation and

boundary and the eastern boundary of Portion 262 southerly to Irwins Creek, by that creek downwards to the northern boundary of Lot 23, DP753678, by that boundary and the western boundary of Lot 59 DP753678, generally westerly and southerly to Irwins Creek aforesaid: by that creek and Cope's Creek downwards to the confluence of Cope's Creek with the Gwydir River; by the Gwydir River downwards to the generally northeastern boundary of the Parish of Dingo, County of Murchison; by that boundary generally northwesterly to the easternmost corner of Lot 5, plan catalogued Ms.3059 Ae.R; by the southeastern and southwestern boundary of that lot southwesterly and northwesterly to the westernmost corner of that lot; again by that generally northeastern boundary of that parish generally northwesterly to the southernmost corner of lot 3; by the southwestern boundaries of that lot northwesterly to the westernmost corner of that lot; again by that generally northeastern boundary of that parish generally northwesterly to the southernmost corner of lot 1; by the generally southwestern boundary of that lot generally northwesterly to the westernmost corner of that lot; again by that generally northeastern boundary of that parish generally northwesterly to the southernmost corner of lot 6, Deposited Plan 249163; by the southwestern and western boundaries of that lot and the western boundary of lot 5 northwesterly and northerly to the northernmost corner of the said lot 5; again by that generally northeastern boundary of that parish generally northwesterly to the northeastern corner of portion 2; by part of the northern boundary of that portion westerly to Sandy Creek; by that Creek and Myall Creek downwards and Sheep Station Creek and Reserve Creek upwards to a line along the eastern boundary of portion 22, Parish of Dumboy; by that line northerly to the Moree to Inverell Railway lands; by that railway land westerly to a line along the western boundary of portions 39 and 41, Parish of Gunnee, County of Burnett; by that line northerly to Warialda or Reedy Creek; by that creek upwards to the former site of the road from Graman to Warialda as described in proclamation of Macintyre Shire in *NSW Government Gazette* No. 150 of 1st November 1940; by part of that road northeasterly to the boundary of Ashford Shire as described in *NSW Government Gazette* No. 114 of 17th July 1936; by part of that boundary generally northerly to the easternmost southeastern corner of portion 40, Parish of Ottley, County of Burnett; by boundaries of that portion westerly, southerly, again westerly and northerly to the southern corner of portion 5; by the southwestern boundary of that portion northwesterly; by Ottley's Creek downwards to the southeastern corner of portion 17, Parish of Tucka Tucka, County of Stapylton; by a line along the eastern boundary of that portion and portion 33 northerly to the Macintyre River; and by that river downwards to the point of commencement.

SCHEDULE C

Guyra Shire (as altered)

Area about 4360.48 square kilometres; commencing at the confluence of Gwydir River and Copes Creek at Lake Copeton; and bounded thence by that creek and Irwins Creek upwards to the northern boundary of Lot 23, DP 753678, by that boundary and the western boundary of Lot 59, DP 753678, generally northerly and easterly to Irwins Creek aforesaid: by that creek upwards to the southern prolongation of the eastern boundary of Portion 264, Parish of Swinton, County of Hardinge, by that boundary and the eastern boundary of Portion 262 northerly to the generally northern boundary of the County of Hardinge; by part of that boundary generally

easterly to the eastern boundary of Lot 1, DP 588622; by part of that boundary of northerly, the northern boundaries of Lots 1 and 2 easterly, the generally north eastern boundary of Lot 3, DP 588622 generally south-easterly and a line south-easterly to, again the generally northern boundary of the County of Hardinge; by part of that boundary generally south-easterly, the generally western boundaries of Portions 9 and 10, Parish of Single, and their prolongation, generally southerly to Copes Creek; by that creek upwards to the southern boundary of Portion 35; by that part of that boundary and the generally eastern boundary of that Portion, generally easterly and generally northerly, the southern and eastern boundaries of Portion 11, easterly and northerly, again the generally northern boundary of the County of Hardinge, generally southeasterly to the range forming the southern watershed of Macintyre River on the eastern boundary of Portion 37, Parish of Single; by part of that range generally easterly to the western boundary of Portion 115, Parish of Eden, County of Gough; by part of that boundary southerly, the generally southern and part of the eastern boundaries of that portion generally easterly and northerly to again, the range forming the southern watershed of Macintyre River; by part of that range generally easterly to western boundary of Lot 1, DP 841482; by part of that boundary northerly to the generally southern boundary of the County of Gough; by part of that boundary generally easterly to the generally south-western boundary of Lot 3, DP 786388; by part of that boundary and a line north-westerly, the generally south-eastern boundary of Lot 1, DP 786388 generally north-easterly, a line easterly, part of the generally south-western and part of the eastern boundaries of Lot 2, DP 786388 generally south-easterly and northerly to again the range forming the southern watershed of Macintyre River; by part of that range and Waterloo Range generally easterly and Great Dividing Range south-easterly to the northern boundary of Portion 22, Parish of Ben Lomond; by part of that boundary, the western and part of the southern boundaries of that portion westerly, southerly and easterly to again the Great Dividing Range; by that range generally south-easterly to Inn Road; by that road generally easterly to the southern prolongation of the western boundary of Lot 1, DP 554313; by that prolongation and boundary northerly, part of the northern boundary of that Lot easterly to the Macleay Range; by that range generally north-easterly to Ben Lomond (Mountain); by a line generally easterly to the generally south-western boundary of Lot 61, DP 705133; by part of that boundary and part of the generally south-eastern boundary of that lot generally south-easterly and generally north-easterly to again a line generally easterly towards Mount Mitchell; by that line to its intersection with the generally north-eastern boundary of Portion 22, Parish of Towagal, County of Clarke; by part of that boundary generally south-easterly to Sara River; by that river downwards and Guy Fawkes River and Pantons Creek upwards to the generally eastern boundary of Portion 49, Parish of Guy Fawkes; by that boundary, the generally eastern boundary of Portion 38, the eastern boundary of Portion 37 and part of the eastern boundary of Portion 35 generally southerly, the northernmost northern and part of the generally eastern boundaries of Portion 36 easterly and generally southerly, the northernmost northern and generally eastern boundaries of Portion 39 easterly and generally southerly, part of the north-eastern boundary of Portion 43 south-easterly, the northern and eastern boundaries of Portion 47, a line, and part of the eastern boundary of Portion 24 easterly and southerly and the generally northern boundary of Portion 26 and its prolongation generally easterly, southerly and

easterly to the road from Armidale to Grafton; by that road generally south-westerly to Macleay Range, aforesaid; by that range generally westerly to the southernmost northern boundary of Portion 20, Parish of Serpentine; by part of that boundary, the eastern most western, the northmost northern and part of the western boundaries of that portion westerly, northerly, westerly and southerly to again the Macleay Range; by that range (in part Snowy Range and Doughboy Range) generally north-westerly to the generally southern boundary of the Parish of Aberfoyle; by part of that boundary generally westerly to Aberfoyle River; by that river upwards to the north-eastern prolongation of the generally north-western boundary of Lot 5, DP 878309; by that prolongation and boundary south-westerly and a south-western boundary of that lot south-easterly and its prolongation to again Aberfoyle River; by that river upwards to generally eastern boundary of the Parish of Legune; by that boundary generally southerly to Wollomombi River; by that river upwards to the generally eastern boundary of the Parish of Wentworth, County of Sandon; by that boundary generally southerly to Gara River; by that river upwards to the generally southern boundary of the Parish of Falconer; by that boundary generally westerly to the New England Highway; by that highway generally southerly to the eastern prolongation of the southern boundary of Portion 156, Parish of Exmouth; by that prolongation and boundary westerly, the western boundary of that portion northerly, part of the southern boundary of Portion 97 westerly, the eastern, the southern and the western boundaries of Portion 110 southerly, westerly and northerly, the western boundary of Lot 1, DP 247235 northerly, part of the southern boundary of Portion 149 westerly, part of the eastern and the southern (and its prolongation) boundaries of Lot 1, DP 104366 westerly, part of the eastern boundary of Lot 5, DP 731475; the eastern boundary of Lot 4, DP 731475, the northernmost eastern, the southernmost northern, the easternmost eastern and its prolongation, the northernmost southern and the generally eastern boundary of Lot 6, DP 260923 and the easternmost eastern boundary of Portion 202 generally southerly, the southern boundary of the lastmentioned portion; a line, and part of the southern boundary of Portion 203 westerly, the eastern and southern boundaries of Portion 21, the southernmost southern and part of the western boundaries of Portion 152 and part of the southern boundary of Lot 2, DP 372798 southerly, westerly, northerly and again westerly to the Main Northern Railway; by that railway generally south-westerly to the generally western boundary of the Parish of Exmouth; by part of that boundary generally northerly to the north-western corner of Portion 76; by a line northerly to Boorolong Creek; by that creek downwards to the southern prolongation of the western boundary of Portion 144; by a line northerly to the generally south-western boundary of Lot 1, DP 859460; by part of that boundary, the westmost western and part of the northern boundaries of that lot generally north-westerly, northerly and easterly to the generally western boundary of the Parish of Exmouth; again by part of that boundary generally northerly and part of the generally northern boundary of the Parish of Boorolong generally westerly to the eastern boundary of Lot 1, DP 515363; by part of that boundary, the generally southern boundary and its western prolongation southerly and generally westerly to the generally eastern boundary of Portion 35, Parish of Williams; by part of that boundary and part of the eastern boundary of Portion 17 generally southerly to the range dividing the waters of Abington Creek from those of Boorolong Creek; by that range generally south-westerly to the southern prolongation of the western boundary of Portion 33, Parish of Sobraon, County of Sandon; by that

prolongation southerly and the eastern prolongation of the southernmost northern boundary of Portion 47, Parish of Sandy Creek, County of Hardinge westerly to the range dividing the waters of Abington Creek from those of Boorolong Creek; again by that range generally south-westerly to the north-eastern prolongation of the south-eastern boundary of Portion 1; by that prolongation south-westerly to the generally northern boundary of that portion; by that boundary generally westerly, part of the western boundary of that portion southerly, the southernmost southern and westernmost generally western boundary of Portion 16 westerly and generally northerly, the northernmost northern boundary of the lastmentioned portion and the northern and part of the western boundaries of Portion 22 westerly and southerly and the southern and western (and its prolongation) boundaries of Portion 15 westerly and northerly to Laura Creek; by that creek downwards to the generally eastern boundary of the Parish of Abington; by part of that boundary generally northerly to Georges Creek; by that creek downwards to the southern prolongation of the western boundary of Portion 22, Parish of Clarkness; by that prolongation, boundary and its prolongation northerly to the southern boundary of Portion 23; by part of that boundary westerly, the western boundaries of the lastmentioned portion, a line, Portions 94, 56, 87, the generally western boundary of Portion 45, a line, and part of the western boundary of Portion 95, Parish of Bundarra generally northerly, the northernmost northern boundary of Portion 20 westerly and the eastern and southern (and its prolongation) boundaries of Portion 34 southerly and westerly to the eastern boundary of Portion 11; by part of that boundary northerly, part of the southern boundary of Portion 48 and the southern boundary of Portion 51 and its prolongation westerly to the westernmost eastern boundary of Portion 7; by part of that boundary northerly and part of the southern boundary of Portion 71 and its prolongation westerly to Gwydir River, aforesaid, and by that river downwards to the point of commencement.

NATIONAL PARKS AND WILDLIFE ACT 1974

Khappinghat Nature Reserve and Saltwater National Park Draft Plan of Management

A draft plan of management for Khappinghat Nature Reserve and Saltwater National Park has been prepared and is on exhibition until 4 February 2013.

The plan may be viewed at the NPWS Manning Area office, 78 Hargreaves Drive, Taree (phone 6552 4097) and Greater Taree City Council Library, 242 Victoria Street, Taree. The plan is also on the website: www.environment.nsw.gov.au (use the 'quicklinks' to 'park management plans').

Written submissions on the plan must be received by The Ranger, Khappinghat NR and Saltwater NP, NPWS, 78 Hargreaves Drive, Taree NSW 2430, through the website or at hunter.region@environment.nsw.gov.au by Monday, 4 February 2013.

All submissions received by NPWS are a matter of public record and are available for public inspection upon request. Your comments on this plan may contain information that is defined as "personal information" under the NSW Privacy and Personal Information Protection Act 1998. The submission of personal information with your comments is voluntary.

NATIONAL PARKS AND WILDLIFE ACT 1974

Lane Cove National Park

Draft Plan of Management

A draft plan of management for Lane Cove National Park has been prepared and is on exhibition until 4 February 2013.

The plan may be viewed at the Lane Cove National Park office, off Lady Game Drive, Chatswood West (phone 8448 0400); Information Centre, Bobbin Head, Ku-ring-gai Chase National Park; Office of Environment and Heritage, Level 14, 59 Goulburn Street, Sydney; Gordon Library, 799 Pacific Highway, Gordon; North Ryde Library, 201 Coxs Road, North Ryde and Turramurra Library, 5 Ray Street, Turramurra. The plan is also on the website: www.environment.nsw.gov.au (use the 'quicklinks' to 'park management plans').

Written submissions on the plan must be received by The Planner, Lane Cove National Park, Lady Game Drive, Chatswood West NSW 2067 or through the website by Monday, 4 February 2013.

All submissions received by NPWS are a matter of public record and are available for inspection upon request. Your comments on this plan may contain information that is defined as "personal information" under the NSW Privacy and Personal Information Protection Act 1998. The submission of personal information with your comments is voluntary.

PESTICIDES ACT 1999

Notice under Section 48 (4)

NOTICE is hereby given, pursuant to section 48 (4) of the Pesticides Act 1999, that I have granted a Pilot (Pesticide Rating) Licence, particulars of which are stated in the Schedule.

SEAN NUNAN,
Team Leader,
Licensing and Registration
by delegation

SCHEDULE

Pilot (Pesticide Rating) Licence

<i>Name and address of licensee</i>	<i>Date of granting of licence</i>
Steven MILLINGTON, 36 Forest Court, Reinscourt WA 6280	8 October 2012

POISONS AND THERAPEUTIC GOODS ACT 1966

Order under Clause 175 (1)

Poisons and Therapeutic Goods Regulation 2008

Withdrawal of Drug Authority

IN accordance with the provisions of clause 175 (1) of the Poisons and Therapeutic Goods Regulation 2008 an Order has been made on CHRISTINE UDY, (NMW0001244685/NMW0001244684), 5/11 Victoria Avenue, Penshurst NSW 2222, prohibiting her until further notice, as a nurse and a midwife from having possession of and supplying drugs of addiction as authorised by clauses 101 and 103 of the Regulation.

This Order is to take effect on and from 12 October 2012.

Dated at Sydney, 5 October 2012.

Dr MARY FOLEY,
Director-General,
NSW Ministry of Health

POISONS AND THERAPEUTIC GOODS ACT 1966

Order under Clause 175 (1)

Poisons and Therapeutic Goods Regulation 2008

Withdrawal of Drug Authority

IN accordance with the provisions of clause 175 (1) of the Poisons and Therapeutic Goods Regulation 2008 an Order has been made on Dr MASOOD ALI KHAN, MED0000939896 of 201 Victoria Street, Potts Point NSW 2011, prohibiting him until further notice, as a medical practitioner from supplying or having possession of drugs of addiction as authorised by clause 101 of the Regulation and issuing a prescription for a drug of addiction as authorised by clause 77 of the Regulation.

This Order is to take effect on and from 12 October 2012.

Dated: 5 October 2012.

Dr MARY FOLEY,
Director-General,
Ministry of Health, New South Wales

PRIVATE ADVERTISEMENTS

COUNCIL NOTICES

ARMIDALE DUMARESQ COUNCIL

Roads Act 1993

Naming of Roads

NOTICE is hereby given that Armidale Dumaresq Council, in pursuance of section 162 of the Roads Act 1993, has officially named the roads as shown hereunder:

<i>Location</i>	<i>Names</i>
In the subdivision of land situated off 7 Gordon Street, being Lot 2, DP 530269.	Schaefer Drive and McGrath Place.
The proposed new road off Dangars Falls Road, being between Lot 129, DP 5455 and Lot 130, DP 5455.	Lochaven Road.

S. BURNS, General Manager, Armidale Dumaresq Council, PO Box 75A, Armidale NSW 2350. [6690]

BATHURST REGIONAL COUNCIL

Roads Act 1993

Land Acquisition (Just Terms Compensation) Act 1991

Notice of Compulsory Acquisition of Land

BATHURST REGIONAL COUNCIL declares with the approval of Her Excellency the Governor that the lands described in the Schedule below, excluding any mines or deposits of minerals in the lands, are acquired by compulsory process in accordance with the provisions of the Land Acquisition (Just Terms Compensation) Act 1991, for road widening. D. SHERLEY, General Manager, Bathurst Regional Council, PMB 17, Bathurst NSW 2795.

SCHEDULE

Lot 5, DP 1135025.
 Lot 8, DP 1135025.
 Lot 9, DP 1135025. [6691]

BLACKTOWN CITY COUNCIL

Local Government Act 1993

Land Acquisition (Just Terms Compensation) Act 1991

Notice of Compulsory Acquisition of Land

BLACKTOWN CITY COUNCIL declares, with the approval of His Excellency the Lieutenant-Governor, that the lands described in the Schedule below, excluding any mines or deposits of minerals in the lands, are acquired by compulsory process in accordance with the provisions of the Land Acquisition (Just Terms Compensation) Act 1991, for environmental conservation. Dated at Blacktown this 20th day of September 2012. RON MOORE, General Manager, Blacktown City Council, PO Box 63, Blacktown NSW 2148.

SCHEDULE

Lot 1, section 35, DP1480.
 Lot 2, section 35, DP1480.
 Lot 3, section 35, DP1480.
 Lot 4, section 35, DP1480.
 Lot 5, section 35, DP1480. [6692]

CAMPBELLTOWN CITY COUNCIL

Roads Act 1993, Section 162

Roads Regulation 2008

Notification of the Naming of Roads

NOTICE is hereby given in accordance with Clause 9 of the Roads Regulation 2008, that Campbelltown City Council has approved the following road names for use in Stage 1 of the residential development of the former Ingleburn Army Camp in the suburb of Bardia:

Arthur Allen Drive	Bardia Avenue
Brallos Street	Derna Street
England Avenue	Mount Olympus Street
Paul Cullen Drive	Retimo Street
Signals Lane	Tempe Street
Vevi Street	Wootten Avenue

PAUL TOSI, General Manager, Campbelltown City Council, PO Box 57, Campbelltown NSW 2560. [6683]

GILGANDRA SHIRE COUNCIL

Local Government Act 1993, Section 50

NOTICE is hereby given that pursuant to section 50 (4) of the Local Government Act 1993, the land described in Schedule 1 below is vested in The Council of the Shire of Gilgandra as Drainage Reserve. PAUL ANTHONY MANN, General Manager, Gilgandra Shire Council, PO Box 23, Gilgandra NSW 2827.

SCHEDULE 1

Lots 33 and 34, DP 17831. [6694]

LANE COVE COUNCIL

Roads Act 1993, Section 16

Dedication of Land as Public Road

NOTICE is hereby given pursuant to section 16 of the Roads Act 1993, that the land described in the Schedule below is dedicated to the public as road. CRAIG WRIGHTSON, General Manager, Lane Cove Council, PO Box 20, Lane Cove NSW 1595.

SCHEDULE

The road reservations in Burns Bay Road and being residue land comprised in Certificate of Title Volume 742, Folios 206 and 207 as shown shaded and edged in grey on the diagrams below.

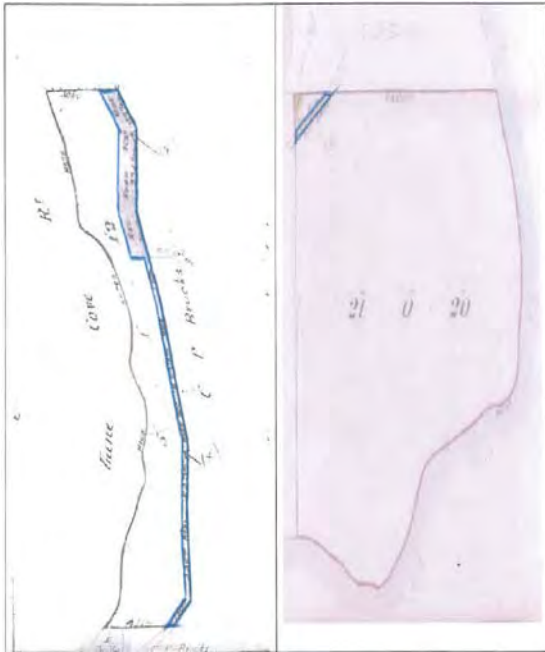

[6695]

LANE COVE COUNCIL

Roads Act 1993, Section 10

Dedication of Land as Public Road

NOTICE is hereby given pursuant to section 10 of the Roads Act 1993, that the land described in the Schedule below is dedicated to the public as road. CRAIG WRIGHTSON, General Manager, Lane Cove Council, PO Box 20, Lane Cove NSW 1595.

SCHEDULE

The road reservations in Burns Bay Road and being land comprised in Lot 1, DP 178290 and edged in grey as shown on the diagram below.



[6696]

SHOALHAVEN CITY COUNCIL

Roads Act 1993, Section 10

Dedication of Land as Public Road

NOTICE is hereby given that in accordance with section 10 of the Roads Act 1993, the land held by Council as described in the Schedule below is hereby dedicated as public road. R. D. PIGG, General Manager, Shoalhaven City Council, Bridge Road, Nowra NSW 2541. File 42354E.

SCHEDULE

That parcel of land known as Lot 2 in Deposited Plan 1159501, Parish of Wollumboola, County of St Vincent, being land adjacent to Redbank Lane, Culburra Beach. [6697]

WYONG SHIRE COUNCIL

Water Management Act 2000

Land Acquisition (Just Terms Compensation) Act 1991

Notice of Compulsory Acquisition of Land

WYONG SHIRE COUNCIL, a water supply authority, declares, with the approval of Her Excellency the Governor, that the interests in land described in Schedule 1 of this notice, the terms of which are described in Schedule 2 to this notice, are acquired by compulsory process by agreement under section 318 of the Water Management Act 2000 and the Land Acquisition (Just Terms Compensation) Act 1991, for water pipeline purposes in connection with the Mardi-Mangrove Link Project. Dated 3 October 2012. MICHAEL WHITTAKER, General Manager, Wyong Shire Council, PO Box 20, Wyong NSW 2259.

SCHEDULE 1

Part of Lot 40, DP 1122514 as particularised in DP 1165895 and therein described as "Proposed easement for water pipeline 10 wide".

Part of Lot 103, DP 739588 as particularised in DP 1165895 and therein described as "Proposed easement for water pipeline 10 wide".

Part of Lot 1, DP 1000387 as particularised in DP 1165895 and therein described as "Proposed easement for water pipeline 10 wide".

Part of Lot 2, DP 1000387 as particularised in DP 1165895 and therein described as "Proposed easement for water pipeline 10 wide".

Part of Lot 1, DP 120512 as particularised in DP 1141981 and therein described as "Proposed easement for water pipeline 12 wide".

Part of Lot A, DP 396415 as particularised in DP 1141981 and therein described as "Proposed easement for water pipeline 12 wide".

Part of Lot 1, DP 554423 as particularised in DP 1141981 and therein described as "Proposed easement for water pipeline variable width".

Part of Lot 103, DP 787369 as particularised in DP 1165895 and therein described as "Proposed easement for water pipeline 10 wide".

Part of Lot 6, DP 562263 as particularised in DP 1165895 and therein described as "Proposed easement for water pipeline 10 wide".

Part of Lot 7, DP 742269 as particularised in DP 1165895 and therein described as “Proposed easement for water pipeline 10 wide”.

Part of Lot 102, DP 787369 as particularised in DP 1165895 and therein described as “Proposed easement for water pipeline 10 wide”.

Part of Lot 1, DP 798770 as particularised in DP 1165895 and therein described as “Proposed easement for water pipeline 10 wide”.

Part of Lot 22, DP 556746 as particularised in DP 1165895 and therein described as “Proposed easement for water pipeline 10 wide”.

Part of Lot 21, DP 556746 as particularised in DP 1165895 and therein described as “Proposed easement for water pipeline 10 wide”.

Part of Lot 1, DP 623542 as particularised in DP 1167980 and therein described as “Proposed easement for water pipeline 10 wide”.

Part of Lot 142, DP 706471 as particularised in DP 1145934 and therein described as “Proposed easement for water pipeline 10 wide”.

Part of Lot 141, DP 706471 as particularised in DP 1145934 and therein described as “Proposed easement for water pipeline 10 wide”.

Part of Lot 1, DP 511787 as particularised in DP 1166806 and therein described as “Proposed easement for water pipeline 10 wide”.

Part of Lot 21, DP 872263 as particularised in DP 1168338 and therein described as “Proposed easement for water pipeline 10 wide”.

Part of Lot 1, DP 635186 as particularised in DP 1163494 and therein described as “Proposed easement for water pipeline 10 wide”.

Part of Lot 114, DP 708550 as particularised in DP 1163494 and therein described as “Proposed easement for water pipeline 10 wide”.

Part of Lot 113, DP 708550 as particularised in DP 1163494 and therein described as “Proposed easement for water pipeline 10 wide”.

Part of Lot 1, DP 715772 as particularised in DP 1163494 and therein described as “Proposed easement for water pipeline 10 wide”.

Part of Lot 12, DP 1083358 as particularised in DP 1163494 and therein described as “Proposed easement for water pipeline 10 wide”.

Part of Lot 2320, DP 1035727 as particularised in DP 1145972 and therein described as “Proposed easement for water pipeline 10 wide”.

Part of Lot 1, DP 558889 as particularised in DP 1145972 and therein described as “Proposed easement for water pipeline 10 wide”.

Part of Lot 11, DP 1083358 as particularised in DP 1145972 and therein described as “Proposed easement for water pipeline 10 wide”.

Part of Lot 100, DP 1133862 as particularised in DP 1163399 and therein described as “Proposed easement for water pipeline 10 wide”.

Part of Lot 32, DP 777362 as particularised in DP 1163399 and therein described as “Proposed easement for water pipeline 10 wide”.

Part of Lot 21, DP 737197 as particularised in DP 1167979 and therein described as “Proposed easement for water pipeline variable width”.

Part of Lot 32, DP 609345 as particularised in DP 1163164 and therein described as “Proposed easement for water pipeline 10 wide”.

Part of Lot 1, DP 1071952 as particularised in DP 1163164 and therein described as “Proposed easement for water pipeline 10 wide”.

Part of Lot 2, DP 1071952 as particularised in DP 1163164 and therein described as “Proposed easement for water pipeline 10 wide”.

Part of Lot 1, DP 240394 as particularised in DP 1163164 and therein described as “Proposed easement for water pipeline 10 wide”.

Part of Lot 2, DP 240394 as particularised in DP 1163164 and therein described as “Proposed easement for water pipeline 10 wide”.

Part of Lot 3, DP 240394 as particularised in DP 1163164 and therein described as “Proposed easement for water pipeline 10 wide”.

Part of Lot 4, DP 240394 as particularised in DP 1163164 and therein described as “Proposed easement for water pipeline 10 wide”.

Part of Lot 5, DP 240394 as particularised in DP 1163164 and therein described as “Proposed easement for water pipeline 10 wide”.

Part of Lot 6, DP 240394 as particularised in DP 1163164 and therein described as “Proposed easement for water pipeline 10 wide”.

Part of Lot 72, DP 1019407 as particularised in DP 1163164 and therein described as “Proposed easement for water pipeline 10 wide”.

Part of Lot 80, DP 717760 as particularised in DP 1166634 and therein described as “Proposed easement for water pipeline 10 wide”.

Part of Lot 8112, DP 877749 as particularised in DP 1166634 and therein described as “Proposed easement for water pipeline 10 wide”.

Part of Lot 61, DP 867170 as particularised in DP 1166634 and therein described as “Proposed easement for water pipeline 10 wide”.

Part of Lot 7, DP 4222 as particularised in DP 1166634 and therein described as “Proposed easement for water pipeline 10 wide”.

Part of Lot 6, DP 755271 as particularised in DP 1166634 and therein described as “Proposed easement for water pipeline 10 wide”.

Part of Lot 62, DP 755271 as particularised in DP 1166634 and therein described as “Proposed easement for water pipeline 10 wide”.

Part of Lot 184, DP 755271 as particularised in DP 1166634 and therein described as “Proposed easement for water pipeline 10 wide”.

Part of Lot 7632, DP 1053267 as particularised in DP 1166634 and therein described as "Proposed easement for water pipeline 10 wide".

Part of Lot 8, DP 755271 as particularised in DP 1166634 and therein described as "Proposed easement for water pipeline 10 wide".

Part of Lot 96, DP 755271 as particularised in DP 1166272 and therein described as "Proposed easement for water pipeline 10 wide".

Part of Lot 192, DP 566582 as particularised in DP 1166272 and therein described as "Proposed easement for water pipeline variable width".

Part of Lot 1, DP 1041876 as particularised in DP 1166272 and therein described as "Proposed easement for water pipeline 10 wide".

Part of Lot 1, DP 90371 as particularised in DP 1166272 and therein described as "Proposed easement for water pipeline variable width".

Part of Lot 95, DP 1101803 as particularised in DP 1166272 and therein described as "Proposed easement for water pipeline 10 wide".

Part of Lot 1, DP 361334 as particularised in DP 1166272 and therein described as "Proposed easement for water pipeline 10 wide".

Part of Lot 101, DP 793748 as particularised in DP 1166272 and therein described as "Proposed easement for water pipeline 10 wide".

SCHEDULE 2

Easement for water pipeline on the terms set out in Registered Memorandum No. AE887061B. [6698]

ESTATE NOTICES

NOTICE of intended distribution of estate. – Any person having any claim upon the estate of RONALD FREDERICK CROCKER, late of Sylvania, in the State of New South Wales, director, who died on 18 April 2012, must send particulars of his claim to the executors, Leanne Marie Hedger and Paul Raymond Crocker, c.o. Newnhams Solicitors, 233 Castlereagh Street, Sydney NSW 2000, within one (1) calendar month from publication of this notice. After that time the executors may distribute the assets of the estate having regard only to the claims of which at the time of distribution they have notice. Probate was granted in New South Wales on 20 September 2012. NEWNHAMS SOLICITORS, Level 7, 233 Castlereagh Street, Sydney NSW 2000 (PO Box 21087, World Square NSW 2002), (DX 11495, Downtown NSW), tel.: (02) 9264 7788. Reference: BLM:JH:7130. [6699]

ISSN 0155-6320

Authorised to be printed
TONY DUCKMANTON, Government Printer.